

What is Corian®

杜邦™可丽耐®



corian.



Let your Imagination Run Free

突破无限 创造无限可能

Let your imagination run free
Corian® is the original solid surface material made by DuPont. Corian® is an advanced composite of natural minerals (aluminium-tri-hydrate, 55%), acrylic (MMA, 40%) and color pigment (5%) developed as a practical material for living. Corian® offers design versatility, function and durability, which is an ideal material to be fabricated into virtually any design.

突破限制，创造无限可能杜邦™可丽耐®的专利科学方法，摆脱天然物料难以加工的缺点，成功糅合天然矿物(氢氧化铝，55%)、树脂中特有的MMA(40%)和颜料(5%)，创造出可媲美天然物料的质感，令产品散发有如接触大自然般的温馨舒泰的感觉，而且可塑性高，实用性强，是任意设计的理想素材。

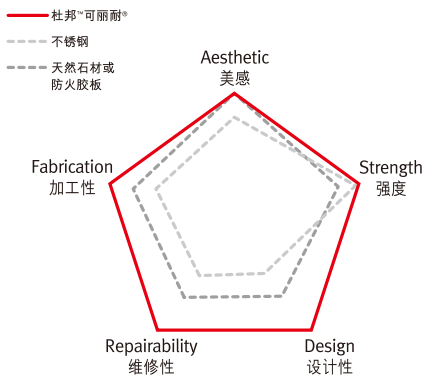

Aesthetic

Colors and pattern running through the entire thickness of material offers elegant touch and feel, making it an ideal aesthetic material for interior designers.

Fabrication

It is easy to fabricate with Corian® such as hole-drilling. Edges can be built to look thicker, and long counters can be easily made in pieces in the workshop and inconspicuously joined together at the installation site, greatly reducing installation time.

Repairability

Stains can be easily removed by cleanser, and scratches can be repaired without marks.

Design

Corian® is workable like wood. Sheets can be combined with our adhesives to make the joints inconspicuous, allowing any design come true.

Strength

- Resistant to impact — take 12mm Corian® as an example, there is no crack for a 450g iron ball at a falling height of 90cm.
- Resistant to heat — yellow stains by cigarette burns can be removed by abrasive cleaner. No visible changes if placing a 350 degree Celsius frying pan onto the surface for 5 minutes, but we recommend using heat insulation mat under the fry pan to make Corian® more durable.
- Resistant to chemicals — sterilizers, cosmetics, food acids, acrylic acids and alcohol would not penetrate into Corian® under daily normal use.
- UV Resistances — Corian® contains methacrylic acid that is UV-resistant, which makes it an ideal material for windowsill, outdoor furniture and exterior wall cladding, etc

美感

表里一致的花纹和色调给人以高级的质感和触感，是室内设计中追求美感表现的材料。

加工性

可以轻易为可丽耐®进行加工和钻孔。此外，专用的接缝黏合剂更可在安装现场接合组成L形的工作台面甚至是U形的厨房装饰用天花板，大大缩短施工时间。

维修性

简单的污渍可用去污剂轻易清除。刮损划痕亦可以轻易修复，不留痕迹。

设计性

拥有与硬木一样的可塑性。接口处可以使用专用的接缝黏合剂接合，做到不明显的接缝效果，使任何设计构思得以实现。

强度

- 耐撞击 — 以12mm的可丽耐®为例，它可以承受一个450g重的钢球从90cm高处直坠下撞击而无任何损伤，证明可丽耐®拥有耐撞击性。
- 耐燃性 — 可以承受香烟的灼热程度，并可用于一般厨房及天花板。即使将350度高温的平底锅置于台面上五分钟亦不会出现损伤。不过，建议在直接放置热锅时加用隔热垫来保护柜面，以延长使用寿命。
- 耐药品性 — 无论是消毒杀菌药品、化妆品、食用酸、丙烯酸及酒精等化学物质在日常使用的情况下均不会侵害可丽耐®实心面材，确保安心使用。
- 阳光直射的位置也可安心使用 — 杜邦™可丽耐®拥有的甲基丙烯酸甲酯是高度防紫外线的物质，可安心用于窗台、户外家具以及外墙等。



Environmental Friendly

保护环境

是世界的潮流
也是我们的追求

DuPont™ Corian® solid surfaces and joint adhesive all have low VOC (volatile organic compound) content. A number of countries have established guidelines and regulations related to the VOC content and emissions of building materials to ensure indoor air quality. Corian® solid surfaces are made from high quality acrylic ingredients, and produced in several manufacturing facilities around the world. Once the ingredients of Corian® are fully reacted (polymerized) in the manufacturing process, they become a chemically stable solid surfacing material with minimal impact on indoor air quality. Besides, Corian® is durable and renewable that fulfills the goal of sustainable design, reducing environmental footprint.

杜邦™可丽耐®实体面材及其同色胶水的VOC含量极低，符合国际性GREEN-GUARD标准。VOC是挥发性有机化合物(Volatile Organic Compound)的简称，很多国家或地区都管制VOC的含量，以减少物料释放出的气味，提高室内空气质量。而杜邦™可丽耐®以高品质的丙烯酸制成，生产技术高超，过程严谨，令产品得到最佳的化学稳定效果，绝不会释出如VOC或二噁英等有害物质，保证室内空气质量。另外，杜邦™可丽耐®持久耐用，容易翻新，可持续使用和配合设计更改，迎合不同的风格转变，缔造新鲜感之余，也能减少资源浪费，保护环境。





杜邦™可丽耐®燃烧时生产的气体

二氧化碳	(1500mg/g)
一氧化碳	(140mg/g)
氯化氢(山埃)	未有发现
氨气	未有发现
硫酸化合物	未有发现
氯化氢	未有发现
窒素酸化物	未有发现

水溶测试

溢出物质

烷基水银化合物、水银或其他化合物、镉或其他化合物、铅或其他化合物、六价铬化合物、砷(砒霜)或其他化合物、硒或其他化合物、铬、铜、锌、锰、钴、镍及钒

结果
无发现

食品卫生机关认证

公告符合美国国家卫生基金会(NSF)51号规格(全部颜色)

Non-toxic

Corian® is an inert, non-toxic, hypoallergenic material. Under normal temperature conditions it does not emit gases. Corian® benefits from the flame-retardant characteristics of aluminium-tri- hydrate; the smoke is optically light and does not contain toxic halogenated gases.

Zero Soluble Toxic Ingredient

Ensuring cooking utensil does not release toxic ingredients after spillage is of paramount importance. Corian® is non-porous and no toxic ingredients are released after water spillage, proving it safe for food preparation.

NSF Standard 51

All colors of Corian® fulfil the requirement of the National Sanitation Foundation (NSF) Standard 51, proving that Corian® is safe for direct food contact, and is an ideal surface for food preparation.

无毒性

可丽耐®为无毒及不引起过敏的物料。在正常温度下，并不会释出气体。即使在燃烧时，也不会释出有毒气体及二噁英。

水溶性有害物质：零

确保食用器具、厨具不会藉水份渗透出有害物质尤其重要。杜邦™可丽耐®的水溶测试结果显示无有害物质，证实可以安心用于处理食物。

美国国家卫生基金会标准第51项

杜邦™可丽耐®所有颜色均合乎美国国家卫生基金会标准(NSF)第51项，证明美国杜邦™可丽耐®可与食物直接接触，及属于适合准备/处理食物范围。



Care and Maintenance 与 保养与维护

Preventing heat damage 预防热力破坏

Corian® is an excellent material for heat resistance. As with all countertop materials, it is important to minimize direct heat exposure to protect your surface and investment. We recommend using heat trivets or hot pads when placing hot objects on any surface. Allow cookware to cool before placing it on any surface or into a Corian® sink.

可丽耐®是耐热的优质面材。与其他面材一样，减少直接热力接触，对保护您的面材及投资是十分重要的。我们建议在摆放沸热器皿时，可使用耐热垫板或具有橡胶垫的三脚架。把器皿放入可丽耐®星盆前，请先将其冷却。

Preventing other damage 预防其他损害

In most cases Corian® can be repaired if accidentally damaged. However, be sure to follow the guidelines here to prevent any permanent damage to Corian®.

- Avoid exposing Corian® to strong chemicals, such as paint removers, oven cleaners, etc. If contact occurs, quickly flush the surface with water.
- Do not cut directly on Corian® countertops.
- Boiling water alone will not damage your Corian® sink, however it's a good practice to run your faucet while pouring boiling water into your sink.

一般而言，可丽耐®台面遭受的损坏均可被修复，但请务必遵从以下指示，以避免永久性的损坏

- 避免让可丽耐®接触强力化学品，如去漆剂、烤箱清洁剂等。如不小心接触，请尽快用水冲洗表面。
- 请勿直接在可丽耐®表面上切割。
- 滚烫的水不会破坏可丽耐®星盆，但最好在倒滚烫的水进星盆时，打开冷水龙头。

Removing minor cuts and scratches 去除切痕及刮伤

Because the solid beauty of Corian® goes all the way through, Corian® surfaces are completely renewable. You can remove minor cuts and scratches yourself by following these instructions.

- Judge the severity of the scratch and start with the finest grit sanding pad to remove the scratch. (The color of the pads from roughest to smoothest are: White, Yellow, Green, Peach, Lilac, Blue, Gray.) Rub over scratch in a straight line to remove it. Periodically switch rubbing direction 90°. Be sure all of the scratch is removed. If this first step takes too long, try the next heavier grit sanding pad. To minimize dust during sanding, wet the surface. Rinse pad periodically to clean residue.
- Clean top with water. Select next lighter grits until desired gloss level is achieved. Rinse out all pads used and air dry before putting them away.

可丽耐®具更新性特质，使其受到切痕或刮伤亦可修复至完整如新。可依照以下指示来去除切痕或刮伤。

- 判断刮痕的严重程度，由最细的砂纸开始清除刮痕。(砂纸由粗到细以下列颜色作区分：白、黄、绿、桃、淡紫、蓝、灰)。以直线方式打磨，来去除刮痕。偶尔转为以直角90度方向来打磨。请确保所有刮痕均被去除。若第一步骤花太多时间，可换粗一级的砂纸。先把台面打湿，以减轻打磨时所产生的尘埃。定期冲洗砂纸，以清除残渣。
- 用水清洗台面。用细一级的砂纸重复以上步骤。大范围地作打磨，以使磨砂效果更均匀。冲洗所有使用过的砂纸，风乾后才收藏。

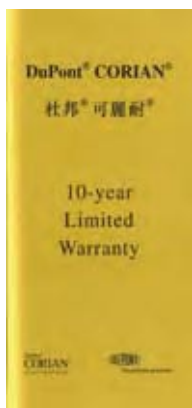

All Finishes		所有表面	
Most dirt & residue	Use soapy water or ammonia based cleaner, rinse and wipe dry.	大部份脏物及污垢	使用肥皂水或一般清洁去污剂，擦干。
Water marks	Wipe with damp cloth and wipe dry.	水渍	先用湿布将水渍拭去，再用干布擦干。
Difficult residue	Spray residue with Deep Cleaner for DuPont®Corian® from Stone Care International, wait for about 30 seconds for cleaner to work. Wipe dry with a paper towel. If residue persists, repeat process. If residue still persists, follow directions for removing scratches.	较难去除的污垢	在污垢上喷上Stone Care International®的强力清洁剂，等待30秒，让清洁剂发挥效用，再用纸巾擦干。若仍有污渍，可重复以上步骤。若仍未能清除污渍，请依照去除切痕和刮伤的步骤。
Disinfecting	Occasionally wipe surface with dilute household bleach (50 part water/1 part bleach). Rinse to pthoroughly with water and wipe dry.	消毒方法	偶尔以经稀释的家庭用漂白水擦拭表面(50份水/1份漂白水)。用水充分冲洗，再用干布擦干净。

Refurbishing Finished Gloss Level		不同光泽表面	
Matte	Rub entire surface with a green Scotch-Brite® pad in a circular motion. Rinse surface with water and wipe dry.	不光泽/哑光面	用绿色的Scotch-brite®*百洁布以划圈方式擦拭整个表面。用水清洗表面，然后擦干。
Semi-gloss	Use a countertop polish (see list below) to help hide scratches and blend in a uniform gloss level.	半光泽表面	使用台面磨光剂来隐藏刮痕，并均匀地融入光泽表面。
High-gloss	Follow steps for semi-gloss or contact your dealer to arrange for professional refurbishment.	高度光泽表面	依照半光泽表面所示的步骤，或与经销商联络，以安排作专业磨光。

Sinks & Lavatories		水槽及洗面盆	
Cleaning	Follow procedures above or use Soft Scrub®** and a green Scotch-Brite®** pad to remove residue. Rub green Scotch-Brite®*pad over entire sink to blend in finish.	清理方法	依照以上步骤，或使用Soft Scrub®**及用绿色的Scotch-Brite®*百洁布来去除残余污渍，为了令表面均匀，请使用绿色的Scotch-Brite®*百洁布来擦拭整个水槽。
Disinfecting	Occasionally fill sink 2/3 full with diluted household bleach (50 part water/1 part bleach). Let stand for over night, then wash sides and bottom as solution drains. Rinse sink with water.	消毒方法	除了日常的清理外，偶尔可倒入约2/3水槽容量，比例为50份水/1份漂白水让其浸泡过夜，再用水冲洗。

* Registered trademark of the 3M Company
 ** Registered trademark of the Clorox Company
 *** Registered trademark of Stone Care International, Inc.

*3M公司的注册商标
 ** Clorox公司的注册商标
 ***Stone Care International, Inc.的注册商标

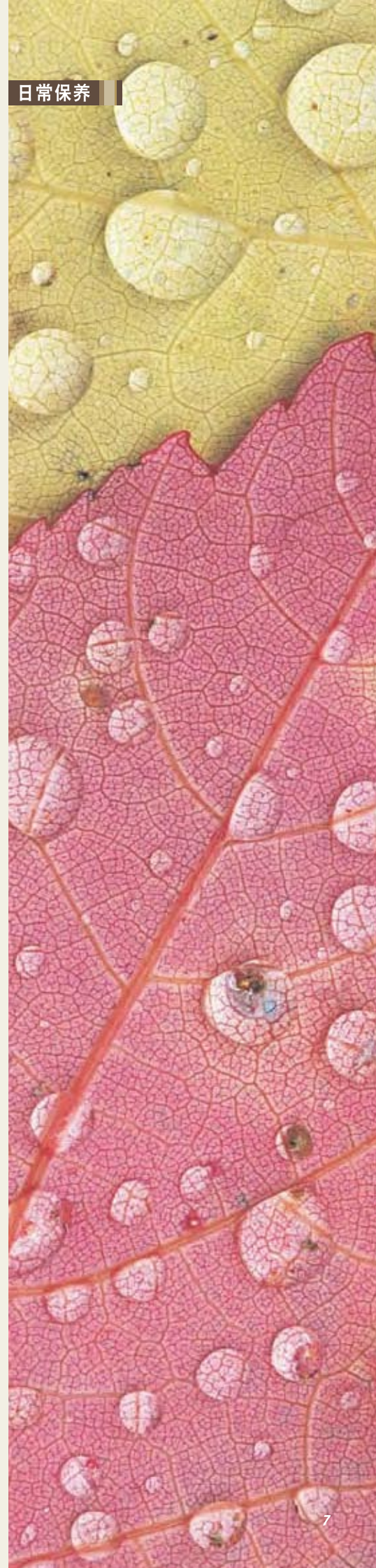

Technical 技术资料 Information

性质 / Property	试验后结果 / Typical Result	试验 / Test
抗拉强度 / Tensile Strength	6,000 psi	ASTM-D-638
抗拉系数 / Tensile Modulus	1.5 x 10 ⁶ psi	ASTM-D-638
伸长率 / Tensile Elongation	0.4% min.	ASTM-D-638
抗弯强度 / Flexural Strength	10,000 psi	ASTM-D-790
抗弯系数 / Flexural Modulus	1.2 x 10 ⁶ psi	ASTM-D-790
硬度 / Hardness	>85 56	洛克威量"M" · 刻度表 Rockwell "M" Scale ASTM-D-785 巴尔可硬度计 Barcol Impressor ASTM-D-2583
热膨胀 / Thermal Expansion	3.02 x 10 ⁻⁵ in. / in. / °C (1.80 x 10 ⁻⁵ in. / in. / °F)	ASTM-D-696
光泽度 / Gloss (60° Gardner)	5-75 (哑光至高度抛光 / matte-highly polished)	ANSI-Z124
抗光照(氙灯) Light Resistance (Xenon Arc)	不变 No effect	NEMA LD 3-2000 Method 3.3
耐磨性及可清洁性 Wear and Cleanability	通过 Passes	ANSI-Z124.3 & Z124.6
抗污性: 板材 Stain Resistance: Sheets	通过 Passes	ANSI-Z124.3 & Z124.6
抗菌效能 Fungus and Bacteria Resistance	不会滋生 Does not support microbial growth	ASTM-G-21 & G-22
表面耐水性 Boiling Water Resistance	没有明显改变 No visible change	NEMA LD 3-2000 Method 3.5
耐高温性 High Temperature Resistance	不变 No change	NEMA LD 3-2000 Method 3.6
伊左得冲击试验(凹度试验) Izod Impact (Notched Specimen)	0.28 ft.-lbs. / in.的凹度	ASTM-D-256 (Method A)
球体耐撞击性: 板材 Ball Impact Resistance: Sheets	无破裂: 半磅重球体 6mm板材: 36英寸掉落 12 ⁺ mm板材: 144英寸掉落 No fracture: 1/2 lb. ball 1/4" slab: 36" drop 1/2" ⁺ slab: 144" drop	NEMA LD 3-2000 Method 3.8
耐候性 Weatherability	ΔE*94<5 (1,000 小时/hrs)	ASTM-G-155
比重 ⁺ Specific Gravity ⁺	1.7	
吸水性 Water Absorption	长时间 / Long-term 0.4% (6mm板材 / 13/4") 0.6% (12 ⁺ mm板材 / 1/2") 0.8% (19mm板材 / 1/4")	ASTM-D-570
毒性 Toxicity	99 (净色系列 / solid colors) 66 (其他色系 / patterned colors)	Pittsburgh Protocol Test ("LC50" Test)
易燃性 Flammability	所有色彩(第一级及A级) All colors (Class 1 and Class A)	ASTM-E-84, NFPA255 & UL723
火焰扩散指数 Flame Spread Index	<25	
烟雾产生指数 Smoke Developed Index	<25	

⁺ 每平方英尺大约之重量: 6mm: 2.2磅 • 12mm: 4.4磅 • 星盆 / 洗面盆符合或超过塑胶星盆及洗面盆的ANSI Z124.3及ANSI Z124.6标准 • NEMA结果根据NEMA LD 3-2000.

⁺ Approximate weight per square foot 1/4" (6mm) 2.2lbs. • 1/2"⁺ (12mm) 4.4lbs. • Shapes meet or exceed the ANSI Z124.3 and ANSI Z124.6 standards for plastic sinks and lavatories.
• NEMA results based on the NEMA LD 3-2000.

Test of 杜邦™可丽耐® DuPont™ Corian® 实体面材 测试

抗污渍性，抗药品性 / Stain-resistant, anti-drug

污染物质 Pollutants	清洁剂 Cleansers	水 Water	厨房清洁剂 Kitchen Cleansers	浓缩清洁剂 Concentrated Cleansers	砂纸 Sand Paper
食料及调味料 Food and Flavourings	豉油 Soy sauce	○			
	咖啡 Coffee	○			
	红茶 Tea	○			
	咖哩粉 Curry powder	△		△	○
	酱汁 Sauce	○			
	威士忌 Whiskey	○			
	辣椒汁 Tabasco	△		○	
	生姜 Red ginger	○			
	辣椒粉 Spice	○			
	橄榄油 Olive oil	○			
文具类 Stationeries	茄汁 Ketchup	○			
	水性箱头笔 Water-base marker	○			
	油性箱头笔 Oil-base marker	X	X	○	
	蜡笔 Crayon	△	○		
化妆品类 Cosmetics	墨汁 Ink	○			
	唇膏 Lipstick	X	△	○	
	染发剂 Hair colorant	X	X	○	
	润肤霜 Lotion	○			
	冷霜 Cold cream	△	○		
	眉笔 Eyebrow pencil	△	○		
家庭用品 Household Products	爽肤水 Toner	○			
	一般化妆液 General liquid	△			
	厨房用漂白水 Kitchen bleach	○			
化学药品类 Chemical Drugs	浴室清洁剂 Bathroom cleanser	○			
	杀虫剂 Insecticide	△	○		
	硫酸 30% Sulfuric acid 30%	○			
	盐酸 35% Hydrochloric acid 35%	○			
	硝酸 10% Nitric acid 10%	○			
	醋酸 5% Acetic acid 5%	○			
	水酸化钠 40% Sodium hydroxide 40%	○			
	碳酸钠 20% Sodium carbonate 20%	○			
	柠檬酸 10% Citric acid 10%	○			
	氨水 28% Ammonia water 28%	○			
	氯化钠 10% Natrium chloratum 10%	○			
	甲醇 95% Methanol 95%	○			
	乙醇 50% Ethanol 50%	○			
	四氯化碳 95% Carbon tetrachloride 95%	○			
	异丙醇 Isopropyl alcohol	○			
	环己烷 Cyclohexane	○			
	甲苯 Methylbenzene	○			
	电油 Gasoline	○			
	灯油(火油) Kerosene	○			
	碘酒 1% Iodine 1%	○			
	丙酮 Acetone	X	△	○	
	染料 Colorant	○			
	亚硫酸氢钠 Sodium hydrogen sulfite	○			
	碘溶液 Iodine solution	△	△		
	尿液 Urine	○			
	苯 Benzene	○			
	福马林杀菌液 Formalin solution	○			
	福马林杀菌蒸气 Steam formalin	○			
	饱和硝酸银 Saturated silver nitrate	○			
	松子酒溶液 Isoqen	○			
石碳酸 5% Phenol 5%	△	△	△	○	

○ 完全清洁 Completely cleaned
△ 轻微残留 Slight residue
X 明显残留 Obvious residue

评定方法:

测试机构自订

(以奶白色调可丽耐®面材放置于摄氏23度空间24小时为准则)

Test Method:

by the testing authority

(placing Cameo White for 24 hours at 23 degree Celsius.)

sinks

单水槽

Single Sinks

The Corian® sinks will blend into any room while adding an air of elegance. The non-porous, stain and moisture-resistant sinks fit right into a Corian® countertop seamlessly.

单水槽

以杜邦™可丽耐®实体面材制造的水槽系列，以简约外型配合流线设计，清雅脱俗，与可丽耐®质料的台面更是配合得天衣无缝，为家居营造简洁一致的时尚气质。



802

外缘尺寸(mm):
L306 x W452 x D127

盆内尺寸(mm):
L256 x W402 x D108

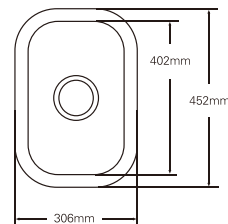
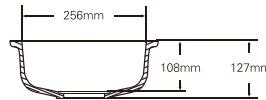

804

外缘尺寸(mm):
L445 x W445 x D223

盆内尺寸(mm):
L401 x W401 x D206

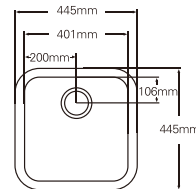
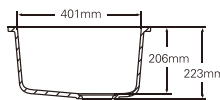

Sinks and Lavatory Bowls

水槽及浴室面盆

double sinks 双水槽

Double Sinks

Double the sink means double the workspace. And these models go beyond practical, with a contemporary style and elegance to complement your design.

双水槽

双水槽系列极具实用性，且备有多款尺寸可供选择，可依您的心意选出最合用的组合。厨房工作台面设计同样细心为您度身订造，生活当然更得心应手。





805

外缘尺寸(mm):
L445 x W496 x D223
盆内尺寸(mm):
L401 x W450 x D206

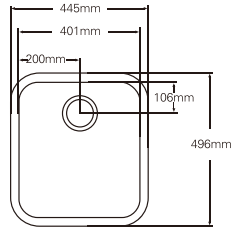
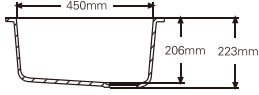

871

外缘尺寸(mm):
L583 x W450 x D201
盆内尺寸(mm):
L533 x W400 x D187

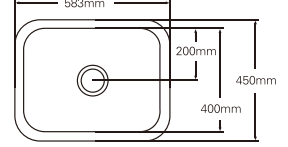
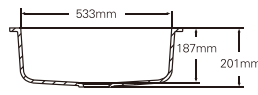

859

外缘尺寸(mm):
L483 x W384 x D210
盆内尺寸(mm):
L439 x W339 x D200

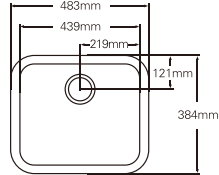
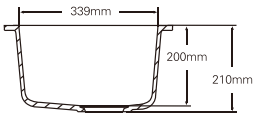

881

外缘尺寸(mm):
L728 x W470 x D229
盆内尺寸(mm):
L690 x W432 x D214

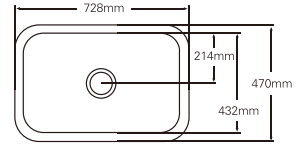

850

外缘尺寸(mm):
L793 x W481 x D243
盆内尺寸(mm):
L348 x W418 x D229
(单盆尺寸, 左右大小相同)

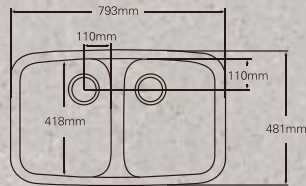
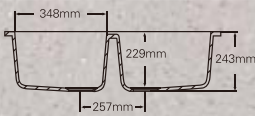

873

外缘尺寸(mm):
L878 x W451 x D207
盆内尺寸(mm):
大盆:
L533 x W400 x D190
小盆:
L254 x W400 x D114

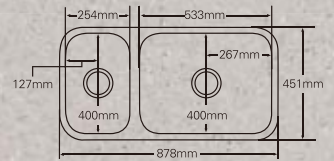
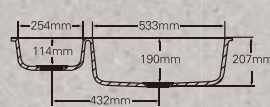

874

外缘尺寸(mm):
L818 x W539 x D243
盆内尺寸(mm):
大盆:
L446 x W486 x D229
小盆:
L287 x W377 x D178

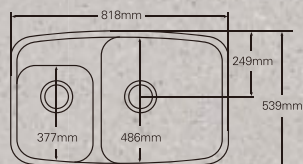
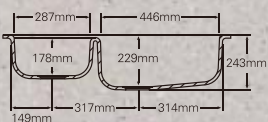

902

外缘尺寸(mm):
L881 x W546 x D269
盆内尺寸(mm):
大盆:
L534 x W469 x D255
小盆:
L252 x W383 x D255

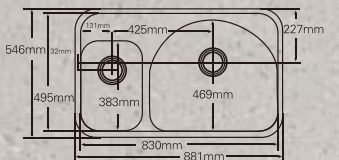
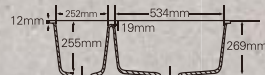

square sinks 方形水槽

Square Sinks

The new Corian® square sinks will blend into any room while adding an air of elegance. The nonporous, stain resistant sinks fit right into a Corian® countertop seamlessly.

方形水槽

全新可丽耐®方形水槽轻松融合各种环境，并增添优雅。其不透水及抗污的特性，和可丽耐®台面天衣无缝地接合。



965

外缘尺寸(mm):
L451 x W451 x D191
盆内尺寸(mm):
L400 x W400 x D176

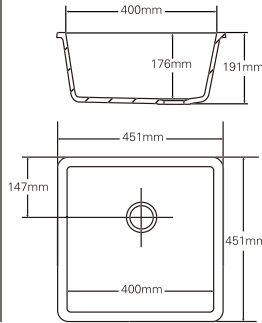

966

外缘尺寸(mm):
L750 x W451 x D191
盆内尺寸(mm):
L700 x W400 x D176

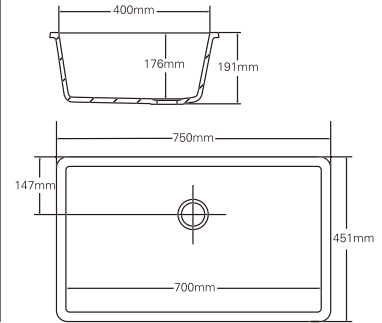

lavatory bowls 浴室面盆

Lavatory Bowls

Corian® lavatory bowls provide beauty, functionality, durability, stain resistance and easy care through years of use.

浴室面盆

由杜邦™可丽耐®实体面材制造的洗面盆系列，造型独特多变，能替平凡的生活空间增添点艺术气息。配合同是可丽耐®质料的台面，感觉更一贯自然。



810

外缘尺寸(mm):
L472 x W386 x D186
盆内尺寸(mm):
L418 x W332 x D138

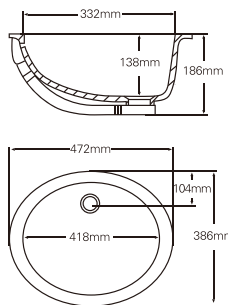

815

外缘尺寸(mm):
L570 x W417 x D207
盆内尺寸(mm):
L520 x W366 x D158

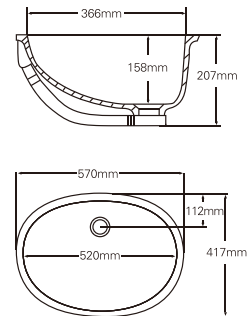

Edges 前线处理



1. Full Bullnose
棋子线

2. Double Roundover
上下修圆线

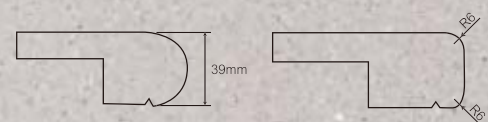

Drainage Patterns 去水花纹





967
 外缘尺寸(mm):
 L211 x W401 x D155
 盆内尺寸(mm):
 L160 x W350 x D140

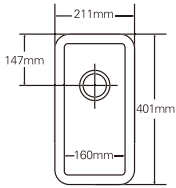
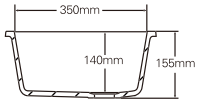

969
 外缘尺寸(mm):
 L381 x W451 x D190
 盆内尺寸(mm):
 L330 x W400 x D175

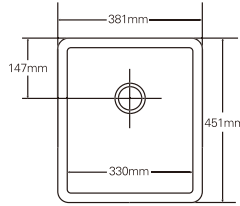
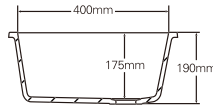

970
 外缘尺寸(mm):
 L581 x W451 x D190
 盆内尺寸(mm):
 L530 x W400 x D175

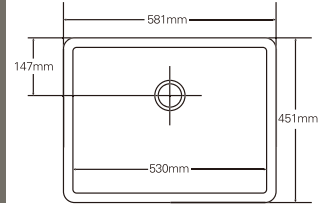
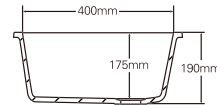

820
 外缘尺寸(mm):
 L421 x W316 x D188
 盆内尺寸(mm):
 L371 x W267 x D139

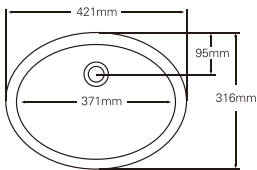
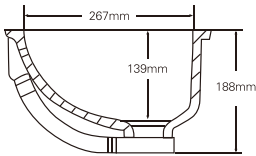

830
 外缘尺寸(mm):
 L529 x W396 x D198
 盆内尺寸(mm):
 L479 x W350 x D149

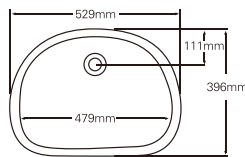
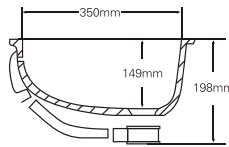

831
 外缘尺寸(mm):
 L559 x W388 x D210
 盆内尺寸(mm):
 L509 x W340 x D159

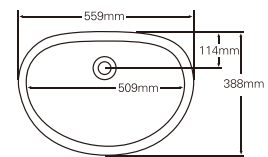
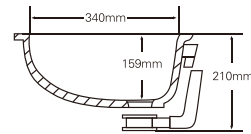

3. Waterfall
前企档水线

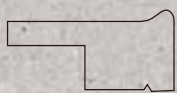

4. Double Bevel
上下斜角线

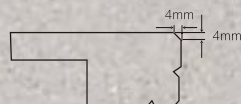

5. Horse Shoes
马蹄圆角线



6. Single Ovolo
跌级圆角线

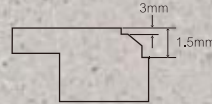

7. Drop Bullnose
跌级棋子线

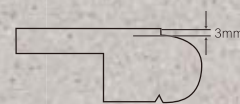

8. Double Pencil Round
上下直角线

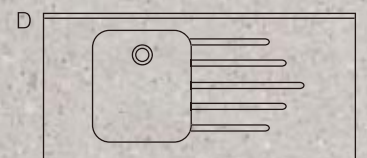
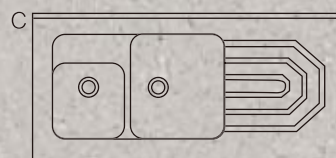
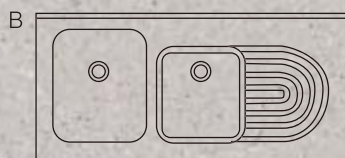
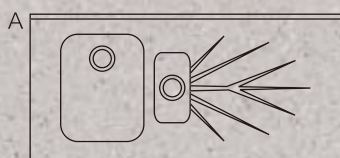
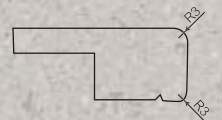



Designer White
设计师白 WN910

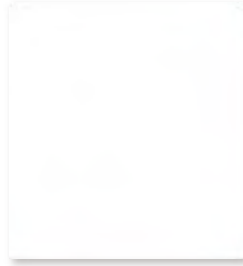

Glacier White
雪白 GW101



Sparkling White
闪晶白 KW922



Cirrus White
云彩白 CR815



Antarctica
南极 MT707



Everest
雪花白 EV502



Linen
亚麻布 LN228



Vanilla
香草 NL114



Whitecap
浪花白 WC720



Rice Paper
米纸 RP230



Whisper
淡沙黄 WH236



Savannah
平原 MV708



Canvas
画布 CV231

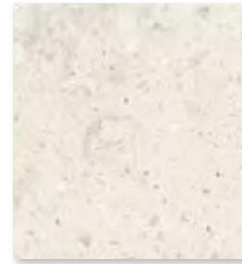

Clam Shell
贝壳 CL801



Mojave
黄沙麻 JV217



Aurora
杏仁麻 AR209



Burled Beach
粗沙 BH802



Sun
太阳 DS903



Mandarin
桔子 DM901



Hot
火红 DH906



Lava Rock
熔石 AAS21



Midnight
黑麻 SM201



Mardi Gras
满天星 DG908



Sparkling Black
闪晶黑 KB923



Black Quartz
黑石英 BQ305

Dark, heavily pigmented Colours of Corian® will show scratches, dust and ordinary wear and tear more readily than lighter, textured colours. We recommend that these colours not be used in applications where the surface is exposed to heavy use and contact (i.e. worktops). These colours are most suitable for applications where surface contact is light and for use as inlays and accent colours. For more information on selecting the ideal Colour of Corian® for your application, please consult with your DuPont™ Corian® representative.

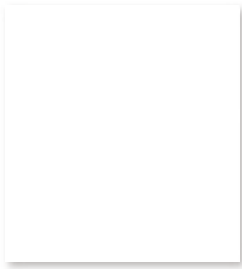

Glacier Ice
冰川白 GC951 **I**



Venaro White
暗纹白 VW606 **I**



Cameo White
奶白 CW103



White Jasmine
茉莉 WJ229



Pearl
珍珠白 RL822 **PC NEW**



Abalone
鲍鱼 AB518



Silver Birch
银华 SB723



Dusk
灰麻 SD203



Dove
灰鸽 DV233



Rain Cloud
雨水白 RC818 **PC**



Sahara
砂褐 MS703



Sandstone
岩石麻 SS204



Fossil
古化石 DJ717



Oyster
生蚝 OY718

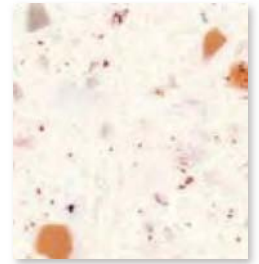

Tumbled Glass
万花筒 TU710



Egyptian Copper
埃及铜 EG805 **PC**



Sonora
粗砂砾 NR807 **PC**



Basil
罗勒棕 JZ823 **PC NEW**

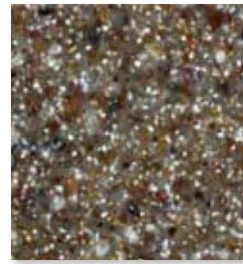

Canyon
峡谷 CN511

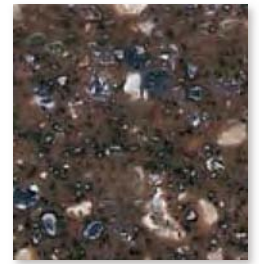

Cocoa Brown
可可棕 CC719



Night Sky
夜空 NS519



Ebony
乌木黑 EO613 **PC NEW**



Nocturne
黑夜 DN902

- PC** Private Collection
珍藏系列
- I** Illumination Collection
半透系列
- NEW** New Product
新产品

深色可丽耐®表面相比浅色可丽耐®容易显现划痕、灰尘和一般的磨损痕迹。我们建议深色可丽耐®最好不要用于操作较频繁的台面(例如操作台)。这些颜色更适用于受损率较少的台面或者作为局部镶嵌和强调使用。想获取更多关于如何挑选适用于您的理想可丽耐®色彩的信息, 请咨询当地的杜邦销售代表。

CONTACT

联系我们

Photo credits (from top to bottom, from left to right)

Cover
Corian® design studio, Shanghai, China; designed by Michael Young; photo courtesy of Fang Lei
Page 2
Corian® Prototile at the royal festival hall, London, England; designed by Future Systems • Toilet in UA KK Mall, Shenzhen, China; design and photo by Alexander Wong Architects Limited; all Rights Reserved

DuPont China Holding Co Ltd Shanghai Branch

Bldg. 11, 399 Keyuan Road
Zhangjiang Hi-Tech Park
Pudong New District
Shanghai 201203, China
Tel: 86-21-3862-2888

杜邦中国集团有限公司 上海分公司

中国上海浦东新区
张江高科技园区
科苑路399号11号楼
邮编: 201203
电话: 86-21-3862-2888

DuPont China Holding Co Ltd Beijing Branch

18F, Gemdale Plaza A
No. 91 Jianguo Road
Beijing 100022, China
Tel: 86-10-8557-1000
Fax: 86-10-8557-1888

杜邦中国集团有限公司 北京分公司

中国北京朝阳区建国路91号
金地中心A座18层
邮编: 100022
电话: 86-10-8557-1000
传真: 86-10-8557-1888

DuPont China Limited

26/F, Tower 6, The Gateway
9 Canton Road, Tsimshatsui
Kowloon, Hong Kong
Tel: 852-2734-5345
Fax: 852-2724-4458

杜邦中国有限公司

香港尖沙咀
广东道9号
港威大厦第6座26楼
电话: 852-2734-5345
传真: 852-2724-4458

DuPont Taiwan Limited

13/F Hung Kuo Building
No 167, Tun Hwa North Road
Taipei 10590, Taiwan
Tel: 886-2-2719-1999
Fax: 886-2-2719-0852

杜邦台湾股份有限公司

台湾台北市10590
敦化北路167号
宏国大厦13楼
电话: 886-2-2719-1999
传真: 886-2-2719-0852

www.corian.com
www.coriandesigninspiration.com



The miracles of science™

* Printed representation of colors may vary from actual samples. For details, please contact your local distributor or dealers.

* 印刷品的色调可能与实物有异，请向各特许代理或分销商查询详情。

Authorized Corian® Dealer

Copyright© 2012 DuPont. All rights reserved. The DuPont Oval Logo, DuPont™, The miracles of science™, Corian® are registered trademarks or trademarks of E. I. du Pont de Nemours and Company or its affiliates. Only DuPont produces Corian®. All rights reserved. EC201101