



DuPont™ Corian®
杜邦™ 可丽耐®

www.corian.com.cn
www.coriandesigninspiration.com

Printed representation of colors may vary from actual samples.
For details, please contact your local distributor or dealers.
印刷品的色调可能与实物有异, 请向各特许代理或分销商查询详情。

Copyright © 2013 DuPont. All rights reserved. The DuPont Oval Logo, DuPont™, The miracles of science™, Corian® are registered trademarks or trademarks of E. I. DuPont de Nemours and Company or its affiliates. Only DuPont produces Corian®. All rights reserved.



The miracles of science™



corian.

目录 Contents

03	品牌定义	Brand
04	可丽耐®的特性	Characteristics
06	可丽耐®对环境保护的关注	Environmental Friendly
09	行业应用	Practical Application
22	色彩	Colors
30	可丽耐®产品	Product
35	胶水	Adhesives
36	技术参数表	Technical Information
38	加工	Fabrication & Finishing
46	保养与维护	Care and Maintenance
49	色谱	Colors



什么是可丽耐®

可丽耐® 由美国杜邦公司于 20 世纪 60 年代创造发明,是世界上第一款人造石,现已被广泛地应用于居家台面、室内外墙面、家具、照明等不同领域,备受全球设计师推崇。历经近 50 多年的强大专业团队的不断研发创新,杜邦™可丽耐® 除了具备无缝拼接、抗污、抑菌、抗冲击的优越特性之外,其强大的可塑性和丰富色彩,可满足任何空间中任何造型的需要,是设计师激发无限创意灵感的最佳首选材料,实现他们对空间美学与实用功能的孜孜苛求,引领现代时尚潮流,让梦想生活触手可及,设计、创造及探索从此无比自由!

What is Corian®

Invented by DuPont in the mid-1960s, Corian® is the original solid surface. Respected by worldwide known designers, it can be used to create countertops, wall cladding, furniture, lighting and many other applications.

With near 50 years of strong research and development, DuPont™ Corian® is a maverick, hygiene, durable, seamless material that can transform any space through unlimited possibility. Crafted into almost anything, in any place, for any purpose, and in a wide palette of colors, it offers the freedom to design, explore and create. DuPont™ Corian® has a 3D formability that has been liberating inventive and artistic minds of designers.

特性

超强耐用

杜邦™可丽耐® 自 1967 年问世以来，显示超强的耐用性。它不会出现脱层状况，能够有效抵抗磨损。它能够抵挡大多数的损伤，如在经常接触的地方的划伤或者切伤。可丽耐® 的机械性能、热传导性能、导电性能以及其他性能都已经得到测试。

安全卫生

杜邦™可丽耐® 是一种无孔材料。质地均匀，可以实现无缝拼接，从而保证面材的卫生安全。杜邦™可丽耐® 实体面材不会滋生细菌或者真菌。可丽耐® 已通过 DIN EN ISO 846 国际标准, 被认定为卫生安全材料。

可修复性

杜邦™可丽耐® 实体面材是可更新的，这就意味着简单地利用温和的研磨清洁剂和磨砂布就可以进行修复。比方说烟头的灼伤痕迹，就可以用这种方法去除。因使用造成的损伤，不需要移动材料, 通过简单地现场操作就可修复。

无毒

杜邦™可丽耐® 为无毒且不会引起过敏的材料。在正常温度下，不会释放出其他挥发物。在燃烧时，主要释放碳水化合物，产生轻烟，不含有毒气体。由于这些优良特性，可丽耐® 已经被广泛应用在公共场所以及一些敏感领域，比如飞机场、医院以及宾馆的墙面及工作台等。

表里如一

可丽耐® 颜色和花纹质地均匀，贯穿整板，并且不会出现褪色状况。杜邦™可丽耐® 是一种实体面材，不会脱层。

无缝拼接

如何应用杜邦™可丽耐® 完全取决于你的想象力。可丽耐® 可以无缝拼接来实现完美效果，提供几乎无限的设计可能性。例如长柜面，就可利用多块可丽耐® 材料在施工现场进行拼接。边缘处亦可以做得更厚实。

热成型

杜邦™可丽耐® 可在木制或金属模具中，在一定温度下进行热成型，制作各种各样的 2D 或者 3D 效果。也可以采用热塑浮雕技术进行压花效果的制作。

透光性

杜邦™可丽耐® 半透光性在浅色系中表现尤为突出。很多设计师正利用可丽耐® 材料进行灯光或者照明效果的设计。

如木材一样的可操作性

杜邦™可丽耐® 能像硬质木材一样利用简单工具进行操作。大多数的杜邦™可丽耐® 加工人员便是从接受木匠培训开始的。

色彩丰富

可丽耐® 几乎包含所有色系。你可以选择单色系, 中性设计; 或者采用多色彩调和以做到引人注目。可丽耐® 也可用于镶嵌或者其他材料如金属、木材、石材等相结合进行设计制作。

环境保护

杜邦™可丽耐® 在生产过程中的各个阶段都严格遵循减少浪费以及能源损耗的原则。不论是材料的本身还是生产安装过程中用到的胶水和密封剂都是经过 GREEN GUARD Indoor AirQuality Certified® 绿色卫士室内空气质量认证的。产生的 VOC 排放量很低。

KEY CHARACTERISTICS

Resistant

Since its introduction in 1967, DuPont™ Corian® has proved itself to be a remarkably durable material that is easy to live with. It cannot delaminate and stands up well to daily wear and tear. It resists most of the impacts, nicks and cuts that occur in heavy traffic areas. Corian® has been tested for its mechanical, thermal, electrical and other surface properties.

Hygienic

DuPont™ Corian® is a non-porous material. It is solid through its entire thickness and can be fabricated with inconspicuous seams, rendering its surface hygienic. DuPont™ Corian® surfaces do not support the growth of bacteria or fungi. Corian® has been certified by an independent laboratory as a hygienic material according to the international norm DIN EN ISO 846.

Repairable

Surfaces in DuPont™ Corian® are renewable, meaning they can be fully restored with ordinary mild abrasive cleansers and a scouring pad. Cigarette burns, for example, can be easily removed in this way. Damage caused by abuse can usually be repaired on site without having to completely replace the material.

Non-toxic

DuPont™ Corian® is an inert and nontoxic material. Under normal temperature conditions, it does not emit gases. When burned, it releases mainly Carbon Oxides and the smoke generated is optically light and does not contain toxic halogenated gases. Because of these properties, Corian® is used in public areas and for sensitive applications such as airport check-in counters, walls and work surfaces in hospitals and hotels.

Solid

Colours and patterns run through the entire thickness of the material and cannot wear away. DuPont™ Corian® is a solid material and cannot delaminate.

Inconspicuous Joints

The applications for DuPont™ Corian® are limited only by your own imagination. Pieces of Corian® can be glued together inconspicuously to create a seamless look, giving virtually unlimited design possibilities for surfaces. Long counters, for example, can be easily made in pieces in a workshop and then joined together at the installation site. Edges can be built up to look thicker.

Thermoformable

DuPont™ Corian® can be thermoformed in wooden or metal moulds at controlled temperatures in order to create various 2D and 3D design objects. Embossing effects can also be created using the Bas Relief technique.

Translucent

The translucency of DuPont™ Corian® is especially striking in the lighter colours as well as with thinner sheets. Many designers are now using the material to create lamps or lighting effects in various applications.

Workable Like Wood

DuPont™ Corian® can be worked likehardwood and using similar tools. Most DuPont™ Corian® fabricators originally trained as carpenters.

Colourful

The colours of Corian® allow for an almost unlimited working palette. You can choose a single colour; a neutral basis for design; or experiment with eyecatching harmonies. Corian® can also be used as inlays, accents, or as a versatile complement to other materials like metal, wood, stone, etc.

Environmentally Friendly

DuPont™ Corian® is manufactured in compliance with strict standards in order to limit waste and energy consumption at all stages of the production process. Both the material itself and the adhesives and sealants used to install it are GREEN GUARD Indoor AirQuality Certified® as producing low VOC emissions.



GREENGUARD® Certificate:
Children & School GreenGuard Indoor
Air Quality Certificate

美国绿色卫士认证：
儿童和学校室内空气质量保证



NSF Standard 51:
Safe for direct food contact
美国国家卫生基金会标准第 51 项：
食品接触认证



**LEADERSHIP IN ENERGY AND
ENVIRONMENTAL DESIGN**
绿色能源与环境设计先锋奖

杜邦™可丽耐® 可持续性

杜邦™可丽耐® 一直致力于发展创新的、令人兴奋的应用，可持续的设计和耐久的建筑解决方案是这些应用的关键。每一天都有更多的消费者、建筑工人、建筑师、设计师选择“营造绿色建筑”。可丽耐® 来自创建于 1802 年的充满企业责任感的杜邦公司，为所有的消费者、建筑工人、建筑师提供“营造绿色建筑”的最佳选择。

耐久性

可丽耐® 拥有很长的生命周期，使用期内几乎不需要置换，通过减少损耗而降低成本，提供超常的经济效益。同时，可丽耐® 可以轻松翻新，恢复原样。

低 VOC 排放

可丽耐® 实体面材、可丽耐® 胶水和密封胶的 VOC 含量和排放量极低，经美国国家标准局(ANSI)认证，获得“绿色防护标章”。它们经第三方认证不含重金属，符合欧盟 2002/95EC 号有害物质禁用指令(RoHS)。

无毒性

杜邦™可丽耐® 无毒且不会引起过敏，在正常温度下不会释放气体。燃烧时，可丽耐® 主要释放二氧化碳，仅生成完全不含有害卤代气体的轻烟。

DuPont™ Corian® Sustainability

DuPont™ Corian® continues to evolve in new and exciting applications where sustainable design and durable building solution are critical. Every day, consumers, builders, architects and designers increasingly choose to “build green”. Corian® is available to them as an environmentally friendly choice from a responsible company operating since 1802.

Durable

Corian® has long life cycles and requires less replacement over time, offering exceptional cost-effectiveness with reduced waste. Corian® can also be easily renewed to original appearance.

Low-VOC emissions

Corian® solid surfaces and cured Corian® adhesives and sealants are GREENGUARD Indoor Air Quality Certified for low VOC content and emissions. They are third party certified to be free of heavy metals, complying with EU Directive 2002/95 EC on the Restriction of Hazardous Substances (RoHS).

Non toxic

DuPont™ Corian® is an inert and non-toxic material. Under normal temperature conditions, it does not emit gases. When burnt, it releases mainly Carbon Oxides and the smoke generated is optically light and does not contain toxic hologenic gases.

无缝 自主

杜邦™可丽耐® 由天然矿物和亚克力树脂制成。其强大的可塑性和丰富的色彩，可充分满足设计师对功能和美观的需求，使其充分发挥想象力和创造力。可丽耐® 不断顺应环境的变化，引领时尚潮流，是设计师和建筑师们创造无限可能的最佳设计材料。

Seamlessness As An Agent Of Liberty

DuPont™ Corian® is an advanced blend of natural minerals and pure acrylic polymer. It is a synthetic material born of human imagination and exploration and the result of a reflection upon the demands of design. To make the most of Corian® in a world of changing environments, fashions and modes of communication, the invitation to designers and architects is to transform this limitless material into a meaningful work of form and function.

10	艺术与家具设计	Art & Furniture Design
11	厨房	Kitchen
12	卫浴	Bathroom
13	外墙应用	Exterior Cladding
14	透光应用	Lighting Solutions
15	医疗保健	Healthcare
16	餐饮服务	Food Service
17	办公室	Offices
18	酒店业	Hotels
19	零售业	Retail
20	交通运输业	Transportation
21	公共空间	Public Space



灵活性 可塑性 可加工性

当流畅的想象力与杜邦™可丽耐® 非比寻常的可塑性碰撞，便可以把想象变为现实。可丽耐® 板材具有天然坚固性，可塑型、可雕刻、可切割性并且可以和别的材料结合，使得我们对椅子，桌子，书架，橱柜和别的物件可以有一个新的视角。可丽耐® 板材可以进行三维变形，呈现曲线，尖角及各种有机形态，赋予作品深刻的内涵。可丽耐® 是一块空白的画布，渴望走进您的生活。

Flexible, Malleable, Workable

When a fluid imagination meets the malleability of Corian® extraordinary results can materialise. The natural solidity of Corian® and its ability to be shaped, carved, engraved and combined with other materials enables new perspectives on seating, tables, bookshelves, cabinets and many other pieces. Morphing in three dimensions with curves, sharp corners and organic forms to give meaning to shape, and shape to meaning, Corian® is a blank canvas yearning to be brought to life.

易清洁 实用卫生 时尚潮流

可丽耐® 装饰的厨房极具个性和品味，使居住者感到居家的和谐和舒适。即使是每个细节，都体现出优雅和积极的生活态度，表达出“我们爱烹饪”的生活主题。杜邦™可丽耐® 极富现代气息，适用于任意风格的厨房环境。它可以无缝地将水槽，柜面和墙体融为一体，兼具艺术的美感和功能的多样性。此外，值得一提的是，卫生、安全、无毒性是可丽耐® 厨房应用的前提优势。

Clean, Functional, Modern

Our kitchens can characterise us, eloquently expressing our rapport with our homes, and with the world around us. Themes can span the spectrum from a minimalist elegance that conceals everything to a “we love to cook” solution where key equipment is openly displayed and celebrated. With its perennially modern personality, DuPont™ Corian® lends itself to almost any style of kitchen design. It permits a fusion of sinks, counters or wall panels without visible seams, offering solutions that are aesthetically harmonious and functionally valuable - with hygiene as a powerful advantage.



健康 优雅 高品质

在住宅领域中没有一个地方像浴室那样，变化快速而多样。浴室是家庭中的天堂，它使得人们可以从日常生活中逃离出来，享受片刻悠闲安然的平静。可丽耐®在浴室的变革中扮演了一个不可或缺的角色。可丽耐®极具可塑性，颜色繁多，触感舒适，使用可丽耐®不仅可以拥有清洁健康，更能体验舒适安心。除此之外，它的抗污渍、抗抓刮、抗霉菌性能使它成为浴室中实用而卫生的好帮手。

Well Being, Elegance, Durability

No space in the residential sphere has changed as rapidly or radically as the bathroom. It is a haven within the home that invites an escape from daily life, and a few moments of pampered peace. Corian® can play an integral role in the evolution of the bathroom. With its formability, extensive colour range and warm touch, it lends itself beautifully to the rituals of cleansing wellness and revitalization. What's more, its resistance to stains, scratches, mould and mildew makes it a practical and sanitary partner.

创新 耐用 非凡魅力

不论是用作外墙还是内部装饰，杜邦™可丽耐®让设计师在上面可以追寻纯粹的、干净的线条和创新的解决方案。这种观念，令人类最基本的需求——房屋——进入了一个新的纪元。可丽耐®耐用、防水的特性使得他可以应用于外墙，也可在房屋的内部发挥其巨大的设计潜力。可丽耐®的高度表现，优雅的外观和卓越的多样化应用，使得它为设计师展现了一个全新的设计可能性。

Innovative, Durable, Irresistible

Whether for exterior cladding or interior decoration, DuPont™ Corian® on vertical lines and inventive solutions. The vision for that most basic of needs—shelter—has entered a new era. The durable, weatherproof qualities of Corian® mean that it can be used to clad a building's exterior as well as for the multiple uses on its interior. Combining high performance, with elegant aesthetics and extraordinary versatility of application, Corian® reveals new vistas of possibility for the designer.



光影 变幻 美轮美奂

部分可丽耐®色彩是半透明的,在光照下,动感光影,明暗层次,一览无余。这一特性使得可丽耐®不仅可应用于室内照明,营造独特氛围;更可用于设计造型时尚的灯具,有灯光装饰的家具和各种具有透光设计的物品,使其具有令人叹为观止的观影效果。杜邦™可丽耐®可选色彩中专为具备透光性质的色彩设立了透光系列,令可丽耐®创造出更多美轮美奂的背光效果。

Bright, Luminous, Shining

Translucent in certain colours and thicknesses, DuPont™ Corian® reveals its full radiance and depth when exposed to light. This quality lends Corian® not only to the creation of atmospheric room-lighting, but also to sensuously shaped lamps, dramatically illuminated furniture, and luminous objects featuring a breathless range of surface effects. DuPont™ Corian® has recently introduced the Illumination Series of colour choices with added translucency to give even greater scope for combining Corian® with stunning backlighting solutions.

卫生 感触舒适

我们身处一个医疗条件先进的时代,没有什么比健康更加重要了。杜邦™可丽耐®无毒、无孔隙、触感舒适,是医疗保健场所的绝好面材,可以应用于手术室、接待区,以及病人浴室和实验室。可丽耐®可进行无缝拼接,非常易于清洁和保养。可丽耐®不会滋生霉菌、真菌和细菌,这样就降低了交叉感染和医院感染疾病的风险。可丽耐®易于加工成符合人体工学的造型,如做成符合安全要求的轮椅。此外,可丽耐®多样的色彩有助于创建一个令医务工作人员和病人都感到自在,舒适的环境。

Hygienic, Warm To The Touch

We live in an era of unprecedented medical advances and nothing is more precious than health. Non-toxic, nonporous and warm to the touch of DuPont™ Corian® offers characteristics that make it an excellent resource for healthcare environments—from operating theatres to reception areas—as well as for patient bathrooms and laboratories. Exceptionally easy to clean and maintain, and joined in a way that creates functionally seamless surfaces, Corian® does not support the growth of mould, mildew or bacteria, thereby reducing the risk of cross-infection and hospital-borne illnesses. It can be easily formed into ergonomic designs, for example to safely accommodate wheelchairs. Last but not least, its range of colours helps to create a comfortable environment where both medical staff and patients can feel at ease.



卫生 易洁 品位高雅

不论是烹饪食物或者享用食物，卫生条件都是不容忽视的。可丽耐® 板材，卫生，耐用，功能性强的特性使得在任何以食物为主的地方，它都是一个理想的选择。从另一个层面来说，掌控颜色，纹理和形状对于营造带来感官诱惑的效果至关重要。可丽耐® 板材无缝隙拼接，触摸起来十分的温暖，这样的材质很容易激发使用者的自信心和信赖感，并且易于保养。易于清洁环境、无毒性、多功能、耐用、易维修……对于创造一个兼具现代优雅和实用的餐饮区域而言，可丽耐® 难道不是最佳选择吗？

Easy To Maintain, Pure, Tasteful

Wherever food is prepared or enjoyed, cleanliness is not an option: it must be optimal. The hygienic, durable and functional properties of Corian® make it ideal for all those realms where food is king. On another level, manipulating colour, texture and shape is central to creating an appealing sensory ensemble. Nonporous, with no visible seams and warm to the touch, this material immediately inspires a sense of confidence and reliability and is easy to maintain. Conducive to a clean environment, non-toxic, versatile, resistant and repairable: what else is needed from a material to create a modern, elegant and practical food area?

耐用 经济 易清洁

工作台面是工作中不可缺少的一部分。作为各种器材放置的地方，它必须有舒适的触感，且有助于激发创造性思维。工作时所处的物理环境可以起到调节工作和工作人员互动的的作用。因此一个友好、坚固、美观、耐用的材料，以符合人体工学的设计，创造出一种健康的工作环境，会更加激发团队的士气。色彩可以影响情绪和工作效率，杜邦™可丽耐® 拥有一个多彩的调色板，可以提供大量可供选择的色谱，除此之外，它还提供了一种现代化的办公风格，打破了严肃呆板的日常办公室生活。可丽耐® 不会渗入墨水和咖啡渍，而且容易清理，可以应用于各种台面、办公室墙面和空间的设计。

Durable, Ergonomic, Easy To Clean

Work surfaces are an integral part of life's labours. Serving as a resting places for all manner of equipment, these surfaces also must be appealing to human touch, and even conducive to an atmosphere of creative thought. Interaction between co-workers is mediated by their physical environment, so a friendly, solid, beautiful, durable material which can be ergonomically shaped, is a key resource for fostering a healthy working environment and encouraging team spirit. Colour can influence mood and productivity and the extensive palette of DuPont™ Corian® offers a broad chromatic spectrum to choose from, yet the material also brings a modern, businesslike, attitude and is sufficiently tough to withstand the daily rigours of office life. Suitable for all types of surfaces, from desktops to meeting tables to kitchenette areas, Corian® is impermeable to ink and coffee stains and is easy to clean.



个性 特色 亲和力

当今世界，个人为了工作或者娱乐而进行的旅行是全球经济中关键的组成部分。当我们在旅途中时，离家万里却希望找到家的感觉，希望高科技能给我们带来既完美又便捷的享受。它必须易清洗且耐用，最好色彩种类繁多且触感舒适，基于上述要求，可丽耐®是酒店行业值得信赖的伙伴。不论是应用于浴室的洗手盆，桌面，接待处还是墙面和空间，每一天，杜邦™可丽耐®都在展示它的风采。可丽耐®的坚固、耐用、无缝保证了它易于保养并且卫生。即使是在旅途中，可丽耐®也能带给您回家的感觉。

Inviting Identity

Today, personal travel for work or pleasure is a linchpin in the planet's economy. When we travel, we seek a home away from home. We want hi-tech perfection, but it has to be convenient. Easy to clean and durable, yet naturally welcoming in its range of colours and warm to the touch, Corian® is a trusted partner for the hotel industry. Whether used to create an identity through a bathroom vanity, guestroom tabletop or reception counter, DuPont™ Corian® performs, day after day. Its solidity, durability and lack of visible seams guarantee easy maintenance and hygiene. Even on your travels, come home to DuPont™ Corian®.

个性 潮流 引人注目

零售环境犹如一个剧院。舞台必须集灯光、材料、色彩和表面处理于一体。可丽耐®的表面触感非常舒服自然。板材质地均匀、半透明且易于加工。它可以制作成各种形状，可以进行蚀刻来展示标志或者呈现背光效果以增添戏剧性。杜邦™可丽耐®用途广泛，可用于如店头、标志、墙壁、陈列柜、柜台、结账处等几乎所有的零售场所。可丽耐®应用无限，可打造出平滑的肌理、迷人的色彩、空灵的光效、令人惊叹的装饰效果和灵感迸发之作，呈现出别样的感官诱惑。

Inviting, Personalised, Structured

Retail environments can be like theatre. The stage must be set using light, material, colour, and surface treatments. The tactile skin of Corian® is inviting and naturally draws the human hand. Homogenous, translucent and easy to work, it can take on almost any form, be etched to showcase a logo or back-lit to add drama. Multi-talented, DuPont™ Corian® can be cast for store fronts, signage and wall cladding, display cases, counters and checkouts in almost any retail setting. Employ the endless design options of Corian® to establish a sensory enticement of smooth textures, inviting colours, ethereal light effects, striking decoration and pure inspiration.



干净 耐用 个性化

航海环境对所用材料有很高的适应性要求。对于豪华游艇和豪华游轮来说，船只的耐用性和美观性一样，是最重要的需求。杜邦™可丽耐® 可以进行切割和塑形，可以准确地安装到船上紧凑的空间中，从而创造出一种独特的、定制的格调，彰显船主的身份地位或是造船公司的卓越品质。可丽耐® 是防水的、天然防渗并且可以应对恶劣天气，因此是用于游轮、渡轮、豪华游艇、舰艇、船屋、海上平台、帆船、摩托艇等绝佳的内饰材料。

Resistant, Clean, Personalised

Nautical environments can be testing, requiring great resilience from mariners and materials alike. Even in the glamorous world of mega yachts and luxury cruising, robust durability is as critical as beautiful form and finish. DuPont™ Corian® can be cut, shaped and joined to adapt precisely to the compact spaces found on boats and to create unique, customised touches conveying the identity of the ship owner or the shipping company. Waterproof, naturally impermeable and resistant to extreme weather, it is the highperformance interior surface of choice for cruise ships, ferries, luxury yachts, naval vessels, houseboats, offshore platforms, sailboats and powerboats.

创新 耐用 亲和力

可丽耐® 适用于博物馆、购物中心、机场休息室、会议室等处，此类应用能发挥其优良的功能。可丽耐® 的持久性和易修补的性能使得它能经得起频繁使用，甚至是偶尔的破坏。同时，它优美的外观、设计的随意性和丰富的色彩可以让设计师们给作品增加更多的个性。

Welcoming, Innovative

Museums, shopping centres, airport lounges, meeting points: Corian® fits in and functions superbly in all these spaces. Its longevity and ability to be repaired means it can stand up to constant use and even occasional abuse, while its beauty, flexibility of design and rich chromatic range allow designers to add individuality.



杜邦™可丽耐® 的绚丽色彩

2013 春意盎然,可丽耐新一季色彩暖心上市
概念取义于自然山川水涧之中
却为生活空间注入更多艺术意象与风格品位
而其无缝可塑的优越特性及 58 种丰富色彩选择
更是实现设计灵感的最佳首选!



Vivid Colors of DuPont™ Corian®

The appreciation of colors has long been vital to human culture and intrinsic to our interpretation of the world around us. In 2013, DuPont™ Corian® brings a new spectrum of 58 multi-sensual colors that enhance the lives of those who enjoy its unique potential; bringing personality and freedom to design to virtually any living space.

净色系列 Solid

大繁若简,是最纯净简单的色彩,却更易于营造舒适惬意的简约空间,让生活回归本源。
Simple colors create a cozy atmosphere for living and working. The natural desire to bring great complications to simplicity is what brings life back to the essence.

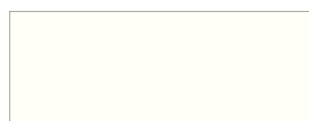

雪白 GW 101
Glacier White

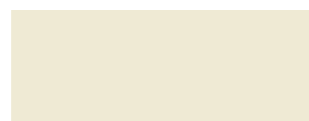

奶白 CW 103
Cameo White

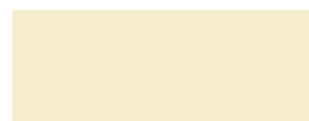

香草 NL 114
Vanilla



珍珠灰 PG 115 **[New]**
Pearl Gray



银灰 SG 116 **[New]**
Silver Gray



墨灰 DG 117 **[New]**
Deep Gray



茶灰 EY 118 **[New]**
Elegant Gray

麻石系 Sierra

媲美真实石岩的自然纹理,带来如沐自然的视觉观感,写意空间更添隽永风格。
Genuine looking rock grain patterns that bring timeless visual impact to living space.



黑麻 SM 201
Midnight



灰麻 SD 203
Dusk



岩石麻 SS 204
Sandstone

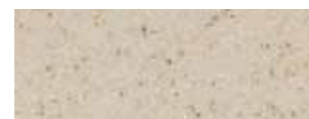

杏仁麻 AR 209
Aurora

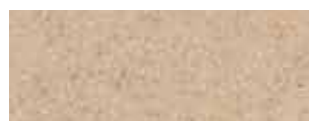

黄沙麻 JV 217
Mojave



亚麻布 LN 228
Linen



茉莉 WJ 229
White Jasmine



米纸 RP 230
Rice Paper



画布 CV 231
Canvas



灰鸽 DV 233
Dove



淡沙黄 WH 236
Whisper

山峰系列 Summit

天然的不规则细粒斑驳,仿佛于空间一角,也能感受到如山峰般巍峨壮阔的舒畅心怀。
Naturally variegated irregularity brings you the comfy emotion that can only experience at the summit.



黑石英 BQ 305
Black Quartz

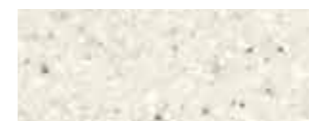

雪花白 EV 502
Everest

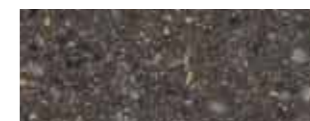

峡谷 CN 511
Canyon



鲍鱼 AB 518
Abalone



夜空 NS 519
Night Sky



棕褐 SI 520 **[New]**
Sienna Brown



墨砥 ED 521 **[New]**
Medea

水纹系 Ripple

清澈纯净似水,人居其中,如临水边,波纹推开散去,滋润柔化每一闲暇好时光。
Inspired by water motion, the ripple effect blends in smoothly with the color as if one is standing in the middle of water.



水纹白 RW 401 **[New]**
White Ripple



水纹灰 RG 402 **[New]**
Gray Ripple

暗纹系列 Venaro

暗暗的自然纹理彼此和谐交融,简单之中却柔和映衬出生活饶趣变化的细致美感。
Natural veining complimenting one another. Simple yet delicately add meticulous aesthetic to designs.

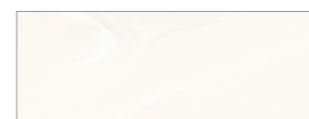

暗纹白 VW 606
Venaro White

晶岩系列 Summit Magna

如同沉睡于内陆深处, 历经岁月洗礼磨砺之后的旧石岩, 表面斑彩细致温雅, 教人玩味。
Just like the lava stones that rest deep beneath the ground, the complex pattern and graining is an interesting story itself.



砂褐 MS 703
Sahara



南极 MT 707
Antarctica



平原 MV 708
Savannah



万花筒 TU 710
Tumbled Glass



古化石 DJ 717
Fossil



可可棕 CC 719
Cocoa Brown



浪花白 WC 720
Whitecap



银桦 SB 723
Silver Birch

设计师系列 Designer Portfolio

鲜亮大胆的色彩, 是设计师对现代风格的鲜明宣示, 是对自我格调的绝对自信。
Bright colors are not only the manifesto by contemporary designers but also a solid confidence of style.



桔子 DM 901
Mandarin



黑夜 DN 902
Nocturne



太阳 DS 903
Sun



火红 DH 906
Hot



设计师白 WN 910
Designer White

闪晶 / 金属系列 Sparklings/ Metallics

如浩瀚宇宙, 繁星点点却又隐没在深邃幽暗的太空之中, 自然神秘又不失浪漫气息。
It's shining among the stars but hidden in the deep universe.
It's mysterious yet romantic.



闪晶白 4B 922
Sparkling White



闪晶墨 AV 925 [New]
Anthracite



闪晶银 VM 924 [New]
Silerite

透光系列 Translucent

色如千年极地冰玉, 质感沁润, 柔和宜人却与冰冷无缘, 心情瞬间回归宁静悠然。
Share the same characteristics with jade, the translucent color is nothing like cold but calm and relax.

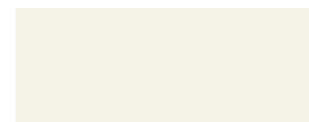

冰川白 GC 951
Glacier Ice

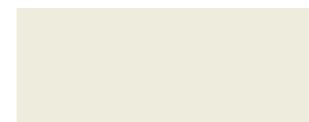

冰月白 IW 952 [New]
Ice White



冰莓蓝 IY 953 [New]
Blueberry Ice



冰薄荷 IM 954 [New]
Mint Ice



大地的恩賜

杜邦™可丽耐® 珍藏系列的自然色彩为板材带来新生命, 突显其优胜之处同时充满大自然美感。

Gift from the Earth

The color palette brings to life the natural minerals within the material, offering all the advantages of Corian® with a look inspired by nature.

珍藏系列
Private Collection

如同自然的臻藏, 初赏色调内敛而沉稳, 细品却回味出更多温润质感带来的高雅气质。
It's truly a natural beauty. Inspired by Mother Nature, the subtle color brings out elegance every time you look at it.



贝壳 CL 801
Clam Shell



粗沙 BH 802
Burled Beach



埃及铜 EG 805
Egyptian Copper



粗沙砾 NR 807
Sonora



云彩白 CR 815
Cirrus White



雨水白 RC 818
Rain Cloud



熔岩石 AA 821
Lava Rock



珍珠白 RL 822
Pearl



罗勒棕 JZ 823
Basil



乌金 MJ 824 [New]
Sorrel

双水槽

双水槽系列极具实用性，且备有多款尺寸可供选择，可依您的心意选出最合用的组合。厨房工作台面设计同样细心为您度身订造，生活当然更得心应手。

Double Sinks

Double the sink means double the workspace. And these models go beyond practical, with a contemporary style and elegance to complement your design.



单水槽

以杜邦™可丽耐® 实体面材制造的水槽系列，以简约外型配合流线设计，清雅脱俗，与可丽耐® 质料的台面更是配合得天衣无缝，为家居营造简洁一致的时尚气质。

Singles Sinks

The Corian® sinks will blend into any room while adding an air of elegance. The non-porous, stain and moisture-resistant sinks fit right into a Corian® countertop seamlessly.

850

外缘尺寸(mm):
L793xW481xD243
盆内尺寸(mm):
L348xW418xD229
(单盆尺寸,左右大小相同)

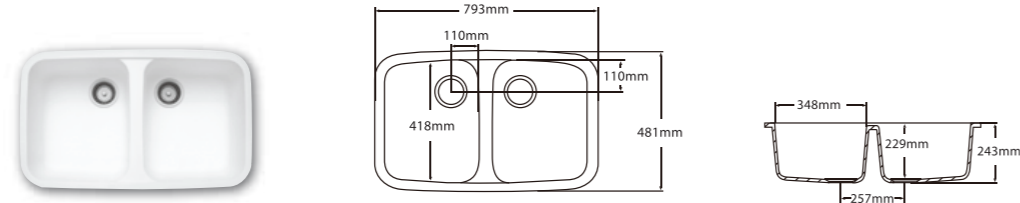

873

外缘尺寸(mm):
L878xW451xD207
盆内尺寸(mm):
大盆:
L533xW400xD190
小盆:
L254xW400xD114

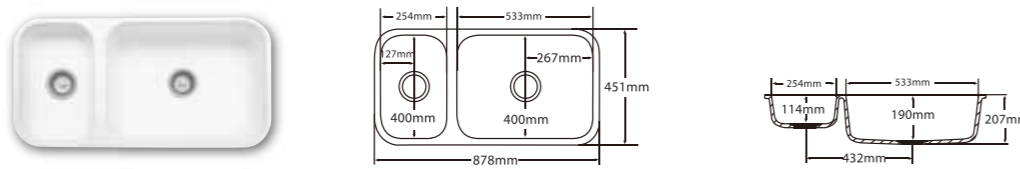

874

外缘尺寸(mm):
L818xW539xD243
盆内尺寸(mm):
大盆:
L446xW486xD229
小盆:
L287xW377xD178

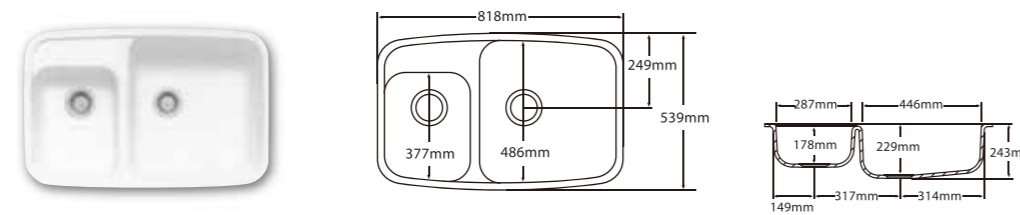

902

外缘尺寸(mm):
L881xW546xD269
盆内尺寸(mm):
大盆:
L534xW469xD255
小盆:
L252xW383xD255

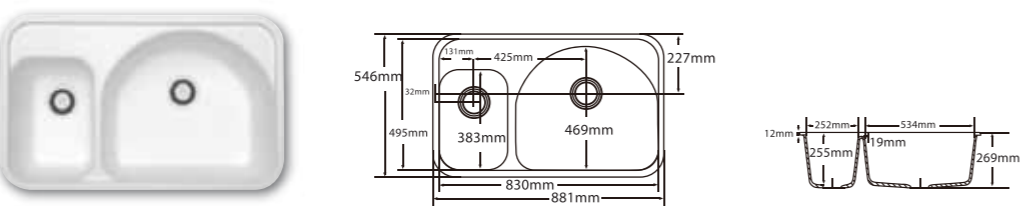

802

外缘尺寸(mm):
L306xW452xD127
盆内尺寸(mm):
L256xW402xD108

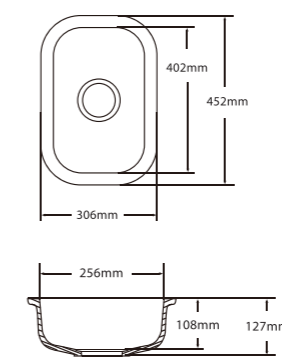

804

外缘尺寸(mm):
L445xW445xD223
盆内尺寸(mm):
L401xW401xD206

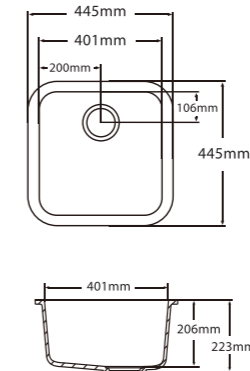

805

外缘尺寸(mm):
L445xW496xD223
盆内尺寸(mm):
L401xW450xD206

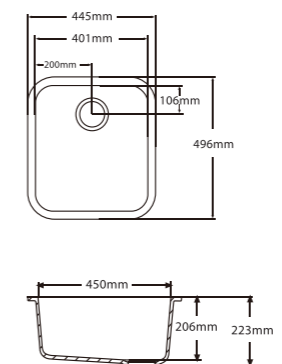

859

外缘尺寸(mm):
L483xW384xD210
盆内尺寸(mm):
L439xW339xD200

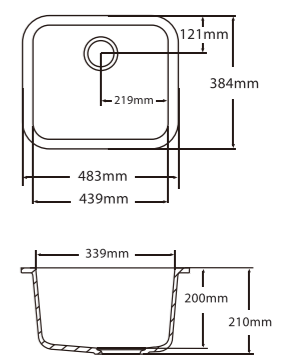

871

外缘尺寸(mm):
L583xW450xD201
盆内尺寸(mm):
L533xW400xD187

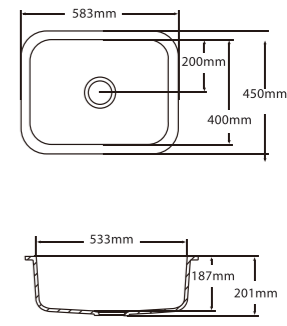

881

外缘尺寸(mm):
L728xW470xD229
盆内尺寸(mm):
L690xW432xD214

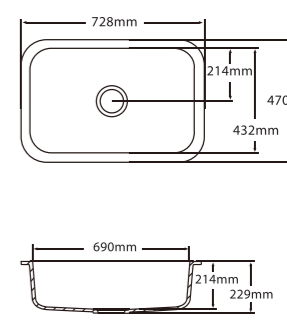

方形水槽

全新可丽耐® 方形水槽轻松融合各种环境，并增添优雅。其不透水及抗污的特性，和可丽耐® 台面天衣无缝地接合。

Square Sinks

The new Corian® square sinks will blend into any room while adding an air of elegance. The nonporous, stain resistant sinks fit right into a Corian® countertop seamlessly.



浴盆面盆

由杜邦™可丽耐® 实体面材制造的洗面盆系列，造型独特多变，能替平凡的生活空间增添点点艺术气息。配合同是可丽耐® 质料的台面，感觉更一贯自然。

Lavatory Bowls

Corian® lavatory bowls provide beauty, functionality, durability, stain resistance and easy care through years of use.

965

外缘尺寸(mm):
L451xW451xD191
盆内尺寸(mm):
L400xW400xD176

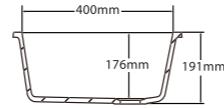
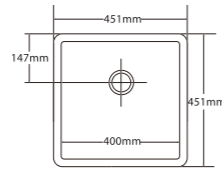

966

外缘尺寸(mm):
L750xW451xD191
盆内尺寸(mm):
L700xW400xD176

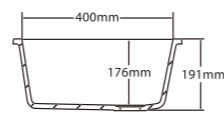
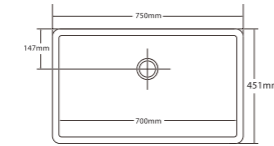

967

外缘尺寸(mm):
L211xW401xD155
盆内尺寸(mm):
L160xW350xD140

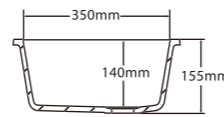
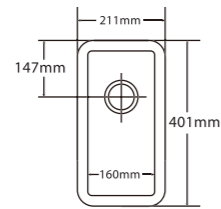

969

外缘尺寸(mm):
L381xW451xD190
盆内尺寸(mm):
L330xW400xD175

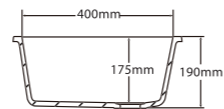
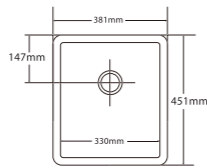

970

外缘尺寸(mm):
L581xW451xD190
盆内尺寸(mm):
L530xW400xD175

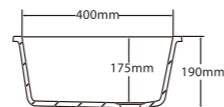
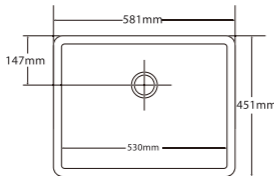

810

外缘尺寸(mm):
L472xW386xD186
盆内尺寸(mm):
L418xW332xD138

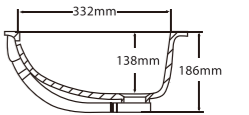
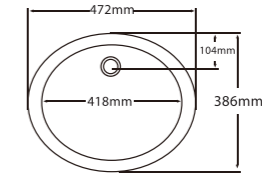

815

外缘尺寸(mm):
L570xW417xD207
盆内尺寸(mm):
L520xW366xD158

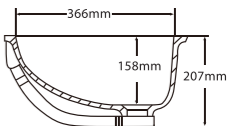
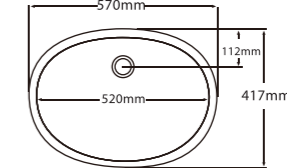

820

外缘尺寸(mm):
L421xW316xD188
盆内尺寸(mm):
L371xW267xD139

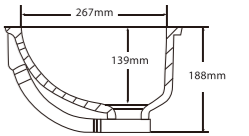
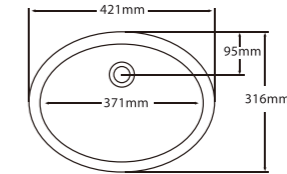

830

外缘尺寸(mm):
L529xW396xD198
盆内尺寸(mm):
L479xW350xD149

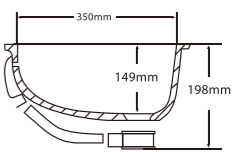
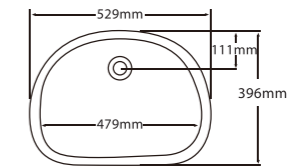

831

外缘尺寸(mm):
L559xW388xD210
盆内尺寸(mm):
L509xW340xD159

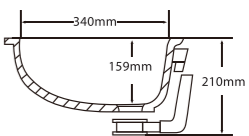
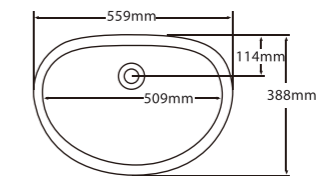



前线处理
Edges

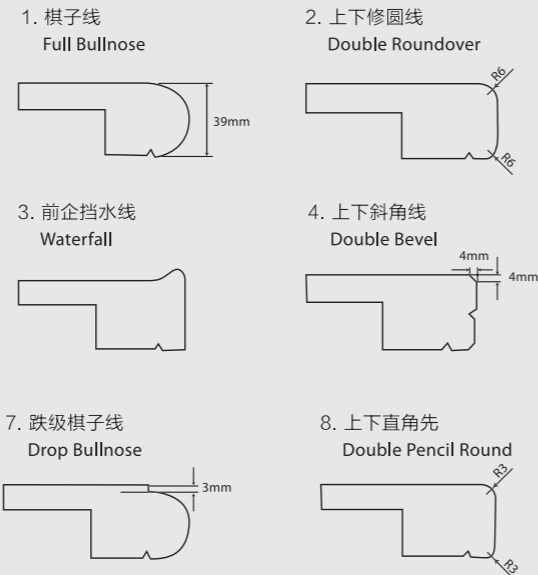

去水花纹
Drainage Patterns

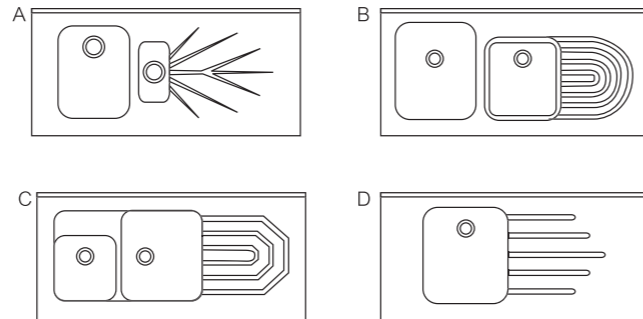

杜邦™可丽耐® 胶水型号及名称 DuPont™ Corian® Adhesive Information

产品系列 Product Family	产品名称 Product Name	产品型号 Product Code	胶水 Adhesives	
			首选 1 st Choice	其它选择 Others
净色系列 Solid	雪白 Glacier White	GW 101	GW14	
	奶白 Cameo White	CW 103	CW12	
	香草 Vanilla	NL 114	CW12	
	珍珠灰 Pearl Gray	PG 115	PG17	LG84
	银灰 Silver Gray	VY 116	VY80	PG17
	墨灰 Deep Gray	DY 117	VY81	ME72
	茶灰 Elegant Gray	EY 118	VY82	
麻石系列 Sierra	黑麻 Midnight	SM 201	SJ20	DN21
	灰麻 Dusk	SD 203	PG17	TP87
	岩石麻 Sandstone	SS 204	BN11	LG84
	杏仁麻 Aurora	AR 209	BN11	DB18
	黄沙麻 Mojave	JV 217	DB18	
	亚麻布 Linen	LN 228	CW12	BI85
	茉莉 White Jasmine	WJ 229	GW14	
	米纸 Rice Paper	RP 230	RP66	GW14
	画布 Canvas	CV 231	CV67	NU60
	灰鸽 Dove	DV 233	DV69	
	淡沙黄 Whisper	WH 236	WH236	
山峰系列 Summit	黑石英 Black Quartz	BQ 305	SJ20	DN21
	雪花白 Everest	EV 502	CW12	GW14
	峡谷 Canyon	CN 511	PG17	DB18
	鲍鱼 Abalone	AB 518	BN11	
	夜空 Night Sky	NS 519	DN21	
	棕褐 Sienna Brown	SI 520	VY83	
	墨砥 Medea	ED 521	ME72	
	暗纹白 Venaro White	VW 606	CW12	DB18
	水纹白 White Ripple	RW 401	CW12	TW77
	水纹灰 Gray Ripple	RG 402	TW77	PG17
	晶岩系列 Summit Magna	砂褐 Sahara	MS 703	BN11
南极 Antarctica		MT 707	GW14	CW12
平原 Savannah		MV 708	DB18	
万花筒 Tumbled Glass		TU 710	TU39	BN11
古化石 Fossil		DJ 717	NU60	
可可棕 Cocoa Brown		CC 719	SJ20	DB86
浪花白 Whitecap		WC 720	WC63	
银桦 Silver Birch		SV 723	GW14	
贝壳 Clam Shell		CL 801	TU39	BN11
粗沙 Burled Beach		BH 802	NU60	
珍藏系列 Private Collection		埃及铜 Egyptian Copper	EG 805	EG70
	粗砂砾 Sonora	NR 807	SR75	
	云彩白 Cirrus White	CR 815	CR79	GW14
	雨水白 Rain Cloud	RC 818	TU39	BN11
	熔岩石 Lava Rock	AA 821	ME72	TW77
	珍珠白 Pearl	RL 822	DB18	CW12
	罗勒棕 Basil	JZ 823	DB18	
	乌金 Sorrel	MJ 824	TW77	
	冰川白 Glacier Ice	GC 951	TW77	
	冰月白 Ice White	IW 952	LG15	DB18
	透光系列 Translucent	冰莓蓝 Blueberry Ice	IY 953	TW77
冰薄荷 Mint Ice		IM 954	TW77	
桔子 Mandarin		DM 901	DM23	
黑夜 Nocturne		DN 902	DN21	
太阳 Sun		DS 903	DB18	
火红 Hot		DH 906	DH25	
设计师白 Designer White		WN 910	GW14	
闪晶系列 Sparklings	闪晶白 Sparkling White	4B 922	GW14	
	闪晶银 Silverite	VM 924	NU76	
	闪晶墨 Anthracite	AN 925	AN78	

杜邦™可丽耐® 推荐胶水对照表 DuPont™ Corian® Adhesive Mapping

BN11	Bone	象牙	VY81	Deep Gray	墨灰	DM23	Orange	桔子	EG70	Egyptian Copper	埃及铜
CW12	Cameo White	奶白	VY82	Elegant Gray	茶灰	DH25	Hot	火红	ME72	Medea	墨砥
GW14	Glacier White	雪白	VY83	Sienna Brown	棕褐	TU39	Tumbled Glass	万花筒	SR75	Sonora	粗砂砾
LG15	Light Green	浅绿	LG84	Light Gray	浅灰	NU60	Neutral	自然色	NU76	Natural Gray	中性灰
PG17	Pearl Gray	珍珠灰	BI85	Bisque	米黄	WC63	Whitecap	浪花白	TW77	Translucent White	透明白
DB18	Dawn Beige	米白	DB86	Dark Brown	深褐	RP66	Rice Paper	米纸	AN78	Anthracite	闪晶墨
SJ20	Jewel	宝石	TP87	Taupe	棕褐	CV67	Canvas	画布	CR79	Cirrus White	云彩白
DN21	Nocturne	黑夜	WH236	Whisper	淡沙黄	DV69	Dove	灰鸽	VY80	Silver Gray	银灰

性质 / Property	试验后结果/Typical Result	试验/Test
抗拉强度 / Tensile Strength	6,000 psi	ASTM-D-638
抗拉系数 / Tensile Modulus	1.5 x 10 ⁶ psi	ASTM-D-638
伸长率 / Tensile Elongation	0.4% min	ASTM-D-638
抗弯强度 / Flexural Strength	10,000 psi	ASTM-D-790
抗弯系数 / Flexural Modulus	1.2 x 10 ⁶ psi	ASTM-D-790
硬度 / Hardness	>85	洛克威量“M”，刻度表
	56	巴尔可硬度计
		ASTM-D-2583
热膨胀 / Thermal Expansion	3.02 x 10 ⁻⁵ in./in./°C (1.8 x 10 ⁻⁵ in./in./°F)	ASTM-D-696
光泽度 / Gloss(60°Gardner)	5-75(哑光至高度抛光 / matte-highly polished)	ANSI-Z124
抗光照 (氙灯) / Light Resistance	不变/No effect	NEMA LD 3-2000 Method 3.3
耐摩擦性及可情节性 / Wear and Cleanability	通过/Passes	ANSI-Z124.3 & Z124.6
抗污性: 板材 / Stain Resistance:Sheets	通过/Passes	ANSI-Z124.3 & Z124.6
抗菌效能 / Fungus and Bacteria Resistance	不会滋生 / Does not support microbial growth	ASTM-G-21 & G-22
表面耐热水性 / Boiling Water Resistance	没有明显改变 / No visible change	NEMA LD 3-2000 Method 3.5
耐高温度性 / High Temperature Resistance	不变 / No change	NEMA LD 3-2000 Method 3.6
伊左得冲击试验 (凹度实验) Izod Impact(Notched Specimen)	0.28 ft.-lbs./in.的凹度 (0.28 ft.-lbs./in. of notch)	ASTM-D-256 (Method A)
球体耐撞击性: 板材 / Ball Impact Resistance:Sheets	无破裂: 半磅重球体 / No fracture	NEMA LD 3-2000 Method 3.8
	6mm板材: 36英寸掉落	
	12+mm板材: 144英寸掉落	
耐候性 / Weatherability	ΔE * ₉₄ < 5 (1,000小时 / hrs)	ASTM-G-155
比重+ / Specific Gravity+	1.7	
吸水性 / Water Absorption	长时间/Longe-term	ASTM-D-570
	0.4% (6mm板材/13/4”)	
	0.6% (12+mm板材/1/2”)	
	0.8% (19mm板材/1/4”)	
毒性 / Toxicity	99 (净色系列/Solid Colors)	Pittsburgh Protocol Test
	66 (其他色彩/Patterned Colors)	(“LC50”Test)
易燃性 / Flammability	所有色彩 (第一级及A级) All colors(Class 1 and Class A)	ASTM-E-84,NFPA255&UL723
火焰扩散指数 / Flame Spread Index	<25	
烟雾产生指数 / Smoke Developed Index	<25	

+ 每平方英尺大约之重量: 6mm: 2.2磅 • 12mm: 4.4磅 • 星盆/洗面盆符合或超过塑胶星盆及洗面盆的ANSI Z124.3及ANSI Z124.6标准 • NEMA结果根据NEMA LD 3-2000。

+ Approximate weight per square foot 1/4”(6mm)2.2lbs. • 1/2”(12mm)4.4lbs. • Shapes meet or exceed the ANSI Z124.3 and ANSI Z124.6 standards for plastic sinks and lavatories. • NEMA results based on the NENA LD 3-2000.

抗污渍性, 抗药品性 / Stain-resistant, Anti-drug

污染物质 Pollutants	清洁剂 Cleansers	水 Water	厨房清洁剂 Kitchen Cleansers	浓缩清洁剂 Concentrated Cleansers	砂纸 Sand Paper
食料-调味料 Food and Flavourings					
豉油 Soy Sauce		○			
咖啡 Coffee		○			
红茶 Tea		○			
咖喱粉 Curry Powder		Δ			
酱汁 Sauce		○	Δ	○	
威士忌 Whiskey		○			
辣椒汁 Tabasco		Δ	○		
红姜 Red Ginger		○			
辣椒粉 Spice		○			
橄榄油 Olive Oil		○			
茄汁 Ketchup		○			
文房具类 Stationeries					
水性箱头笔 Water-base Marker		○			
油性箱头笔 Oil-base Marker		x	x	○	
蜡笔 Crayon		Δ	○		
墨汁 Ink		○			
化妆品类 Cosmetics					
口唇膏 Lipstick		x			
染发剂 Hair Colorant		x	Δ	○	
润肤霜 Lotion		○	x	○	
冷霜 Cold Cream		Δ			
眉笔 Eyebrow Pencil		Δ	○		
爽肤水 Toner		○	○		
一般化妆液 General Liquid		Δ			
家庭用品 Household Products					
厨房用漂白水 Kitchen Bleach		○			
浴室清洁剂 Bathroom Cleanser		○			
杀虫剂 Insecticide		Δ	○		
化学药品类 Chemical Drugs					
硫酸30% Sulfuric Acid 30%		○			
盐酸35% Hydrochloric Acid 35%		○			
硝酸10% Nitric Acid 10%		○			
水酸化钠40% Sodium Hydroxide 40%		○			
碳酸钠20% Sodium Carbonate 20%		○			
柠檬酸10% Citric Acid 10%		○			
氨水28% Ammonia Water 28%		○			
氯化钠10% Natrium Chloratum 10%		○			
甲醇95% Methanol 95%		○			
乙醇50% Ethanol 50%		○			
四氯化碳素95% Carbon Tetrachlorate 10%		○			
异丙醇 Isopropyl Alcohol		○			
环乙烷 Cyclohexane		○			
甲苯 Methylbenzene		○			
电油 Gasoline		○			
灯油 (火油) Kerosene		○			
碘酒 1% iodine 1%		○			
丙酮 Acetone		x	Δ	○	
染料 Colorant		○			
亚硫酸氢钠 Sodium Hydrogen Sulfite		○			
碘溶液 Iodine Solution		Δ	Δ		
尿液 Urine		○			
苯 Benzene		○			
福马林杀菌液 Formalin Solution		○			
福马林杀菌蒸气 Steam Formalin		○			
饱和硝酸银 Saturated Silver Nitrate		○			
松子酒溶液 Isoqen		○			
石碳酸5% Phenol 5%		Δ	Δ	Δ	○

○ 完全清洁 Completely Cleaned Δ 轻微残留 Slight Residue x 明显残留 Obvious Residue

评定方法: 测试机构自定(以奶白色调可丽耐®面材放置于摄氏23度空间24小时为准则) Test method: by the testing authority (placing Cameo White for 24 hours at 23 degree Celcius.)



制作胶合板模具
Plywood male and female mould



热成型
Thermoformed parts



将壳的两部分结合
Applying DuPont™ Corian® joint adhesive to the seam



两片材料组成一组（四分之一）
Seaming of 2 segments to make a quarter



四分之一部分完成
Finished quarterpiece



两组组成一个半球
Assembly of 2 quarter pieces to half a shell



最终的修整
Final trimming of the shell



最后打磨
Final sanding of the shell



两部分拼接完成
Assembly of 2 halves of a shell



最终组装
Final assembly of the shell



创作的不同工序

左边的工序揭示了如何利用杜邦™可丽耐®材料快速进行制作加工。以制作一个创新型音响系统的过程为例。可以清楚地看到利用杜邦™可丽耐®进行产品制作不只是工艺过程,更是一个创新过程。

Different Ways To Create

The process left illustrates how DuPont™ Corian® can be transformed from sheets into, for example, an innovative speaker mounting system. It can be clearly seen here that creating with DuPont™ Corian® is an exercise of both craftsmanship and innovation.

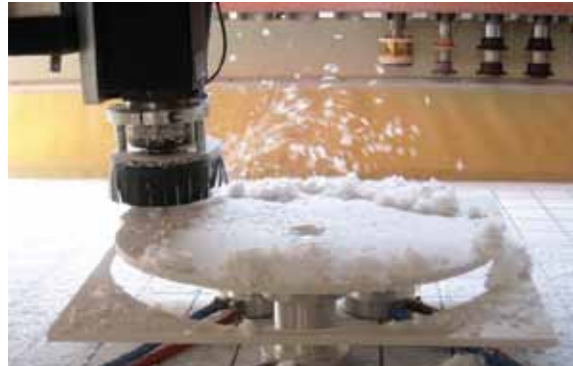

基本加工技巧

杜邦™可丽耐® 兼具石材的稳定性与硬质木材的可加工性。本手册无法囊括全部的加工技术，但是下面的几部分介绍可丽耐® 加工过程中的主要工艺；

切割

杜邦™可丽耐® 比木材硬度要高。为了将整块材料切割成希望的形状尺寸，所使用的锯和雕刻机等工具必须足够强劲。直角切割用合金头或者金刚石的圆锯进行。曲线切割使用手动雕刻机或者数控机床(CNC)，取决于需要切割的数目 雕刻机必须要有钨硬质合金。

BASIC FABRICATION TECHNIQUES

DuPont™ Corian® is a material which combines the durability of stone with the workability of hardwood. It is impossible to cover all fabrication techniques in this book, but the following sections describe the most important elements.

Cutting

DuPont™ Corian® is harder than wood. In order to cut a full sheet to obtain the desired pieces, saws and routers must be powerful enough to work the material properly. Straight cuts are made with a circular saw with carbide-tipped or diamond-tipped teeth. Curved cuts are made with manual routers or with numerically controlled routers (CNC), depending on the number of identical pieces that need to be cut. Rounded inside corners are routed in order to prevent cracking. Router bits must have tungsten carbide tips.

接合

接合可丽耐® 板材时，请务必确保板材边缘为笔直的直角边缘，并在用粘合剂接合之前，用干净的白布蘸取酒精把所有的边缘彻底清洁。为了达到光滑、隐蔽的无缝接合效果，请务必使用与可丽耐® 板材颜色一致的杜邦™可丽耐® 专用粘合剂——这是杜邦™可丽耐® 的主要特点之一。

打磨

对可丽耐® 实体面材进行磨光处理，应使用旋转式砂光机，按照“从上到下，从左至右”的方向和顺序，以打圈的方式进行打磨。打磨可丽耐® 应分步骤进行，从使用粗砂纸开始打磨，然后再使用较细的砂纸打磨。磨光效果根据设计师的需求不同而不同，从哑光效果到高光泽度效果都能够实现。杜邦建议将可丽耐® 打磨为半哑光效果，节约工时也方便维护。高光泽度的可丽耐® 可能会逐渐褪去光泽，特别是在使用密度较高的区域。

Seaming

All the edges of the pieces to be joined must be straight, square and thoroughly cleaned using ethanol on a clean white cloth before applying adhesive. Two-component DuPont™ Corian® joint adhesive in the appropriate matching colour should be used to obtain inconspicuous seams - one of the key features of DuPont™ Corian®.

Sanding

Surfaces are sanded with a random orbital sander following the “North-South, East-West” direction using small circular motions. Sanding is to be done in several steps from rough to fine grades of sandpaper. The finish can be varied from matt to high-gloss, depending on the effect the designer wishes to obtain. DuPont suggests a semi-matt finish, which is the easiest finish to obtain and maintain. High-gloss finishes tend to dull over time, especially in areas which see intense use.



高级的加工技术

热成型

在大约 160°C 的高温条件下，利用胶合板或金属铸模可以将杜邦™可丽耐® 加工成各种形状。依据板材的厚度和颜色，可丽耐® 板材能够热塑成最小内半径为 25mm 的各种二维形状。即使在铸模中冷却，也能够避免残余应力而制作出优秀的作品。可丽耐® 热塑成型的能力根据板材色相饱和度与微粒的不同而有所变化。

镶嵌

杜邦™可丽耐® 可以与其他材料镶嵌或者在不同颜色的杜邦™可丽耐® 材料之间进行镶嵌操作可以增强材料的美观。很多材料都能适合与可丽耐® 进行镶嵌。不建议与大面积金属材料进行镶嵌，因为他们具有较高的热膨胀系数。另外，在杜邦™可丽耐® 材料上可以很轻松地进行标识的制作镶嵌。

ADVANCED FABRICATION TECHNIQUES

Thermoforming

DuPont™ Corian® can be thermoformed using plywood or metal moulds at temperatures of approximately 160°C. DuPont™ Corian® may be formed up to an internal radius starting at 25 mm with two dimensional thermoforming, depending on the thickness and the colour of the sheet. Even cooling in the mould will prevent residual stresses and provide superior results. Thermoformability differs depending on the saturation or particle loads in the sheet.

Inlays

Inlaying DuPont™ Corian® with different materials or with different colours of DuPont™ Corian® can enhance the inherent beauty of the material. Various inlay materials are compatible with DuPont™ Corian®. DuPont suggests avoiding large inlays containing metals because of their high thermal expansion coefficients. Logos can be easily created using inlays in DuPont™ Corian®.



热转印

这种技术被称作“热转印图像传输”，它可以帮助设计师以一种全新的方式个性化地加工可丽耐®材料。这一工序包括将图像搬到可丽耐®材料块上，就像是人的纹身，可以在面材上永久刻下图像。然后，还可以像未刻上图像一样对可丽耐®材料进行重新抛光和热成型。热转印图像传输就像是一种全新的交流方式，可以帮助设计师、工程师和建筑师更好地表达出自己的创意思法。

半透明

使用半透明颜色材料或者减少标准杜邦™可丽耐®材料的厚度都可以达到半透明的效果。

照明系列

背光情况下，材料的颜色效果变化显著。当设计在材料后面的光源开启之后，材料柔和的外观会被光源的美学变化所替代。你要做的就是大胆去开拓创意！尝试每一种光源方案，可以发现很多白光光源的不同变化和色调，也会看到彩色光叹为观止的效果。你肯定会被无限的可能性所折服。

Sublimation

Known as “image transfer by sublimation”, this technique allows designers to personalise DuPont™ Corian® in a completely new way. The sublimation process consists of transferring images into a sheet of DuPont™ Corian® so that - almost like a human tattoo a permanent image is created within the surface. The printed DuPont™ Corian® can then be re-polished and thermoformed in the same way as unprinted DuPont™ Corian®. Image transfer by sublimation is a new tool for communication and for enhancing creative expression by designers, engineers and architects.

Translucency

Tran slucet effects can be obtained via the use of translucent colours or by reducing the thickness of standard DuPont™ Corian® colours.

The illumination series

The colour effects from these materials change dramatically when backlit. When the lighting system behind your design is turned on, the pastel appearance disappears and the appearance is dominated by the aesthetics of the light source. Be creative! Test each one of these with different types of light sources to see the many variations and shades of white light and the effects using coloured light. You will be amazed by the possibilities!



维护

日常维护

杜邦™可丽耐® 易于清洁。用湿布和肥皂水擦拭、油渍和污渍，可以保持材料的清洁卫生，清洁时要使用温和的清洁剂或者普通的家庭去污剂，然后使用柔软的布擦拭。水槽的保洁应该充分擦干，以清除残留油渍及污渍。一周可以进行一次或者两次保养，可以放入部分温水，加上 1-2 茶匙的液体漂白剂，然后放置几个小时或者放置一整晚。为了防止硬水残留的水垢积聚，台面要用湿布擦拭后再擦干。在如排水渠或者水龙头周围等比较容易藏污纳垢的地方，可以偶尔使用家庭除垢剂。

损坏及防护

杜邦™可丽耐® 本质上可以说是“可再生”的，因为它是实体面材。大多数的损坏，包括严重损坏、灼伤或者化学物质损坏，都可以进行现场维修来恢复到原来的光滑干净。杜邦的认证加工商可以为您提供保养和修复服务。

MAINTENANCE

Daily Care

DuPont™ Corian® is easy to clean. Its fresh, hygienic appearance can be maintained by wiping up spills, grease and stains with a damp cloth and soapy water, using ammonia based “hard-surface” cleaner or a mild cream abrasive cleanser or common household degreaser, and then wiping dry with a soft cloth. Sinks should be cleaned thoroughly to remove greasy deposits and stains. Once or twice a week, they should be partially filled with warm water and 1-2 teaspoons of liquid bleach and then left to sit for a few hours or overnight. To prevent lime scale build-up from hard water, counters should be damp-wiped and then dried. In difficult areas, such as around drains or taps, a household lime scale remover can be used occasionally.

Abuse

DuPont™ Corian® is inherently “renewable” because it is solid and homogeneous all the way through. Most damage, including severe impact, heat or chemical damage, can usually be repaired on-site and the original smooth, hygienic solid surface restored. For professional sanding of a DuPont™ Corian® work surface, contact your local supplier, who should be able to refer you to a local DuPont™ Corian® Quality Network Fabricator or Service Centre. DuPont™ Corian® Quality Network Service Centres are approved by DuPont to carry out expert repair work.

建议

灼伤防护

- 使用热的炊具时，请使用隔热架、保护垫，或先让炊具在炉灶上冷却。
- 切忌将热锅，特别是热的铸铁锅直接放置在杜邦™可丽耐® 面材或者水槽中。过热会导致面材损坏。
- 切勿直接将沸水倒入水槽中。
- 选用与炉灶大小相宜的炊具，并且将炊具放置在炉灶中间以避免灼伤周围的面材。

划痕防护

跟所有的材料一样，杜邦™可丽耐® 在日常使用中也会出现轻微的磨损痕迹。请注意以下几点：

- 不要使用利器直接在台面进行食物等的切割，这会导致台面的损伤。建议使用砧板。
- 相比于浅色系和有质感的色系，深色系与暗色系划痕会更明显，灰尘积累与正常磨损也会更明显。

化学品损伤及防护

如果遇到强烈的化学物质的意外泄漏（如脱漆剂，刷子清洁剂，金属清洗剂，烤箱清洁剂，含有二氯甲烷的清洁剂，酸性通渠剂，丙酮基水性指甲油清洗剂等），应立即用大量肥皂水冲洗以避免损坏台面。对于指甲油清洗剂的泄漏，可以使用非丙酮基的卸妆油，然后用水冲洗。未及时发现清除或长期接触化学品可能会损坏台面。

RECOMMENDATIONS

Heat

- Always use a heat protection pad, trivet (with rubber feet) or protective sink mat for hot cookware, or leave cookware to cool on the hob first. Never place hot pans, particularly cast iron pans, directly onto a DuPont™ Corian® top or in a sink. Excessive heat can damage any surface.
- Pouring boiling liquids directly into sinks without turning on the cold tap may damage your DuPont™ Corian® surface.
- Always use the correct-sized pan on the burner and place it centrally since an overhanging pan may scorch the adjacent surfaces.

Scratches

Like all materials, DuPont™ Corian® will develop slight abrasion marks as a result of normal daily use. Please note the following:

- Never cut or chop on DuPont™ Corian® as this will score the work surface. Use a cutting board instead.
- Dark, heavily pigmented colours will show scratches, dust and ordinary wear and tear more readily than lighter, textured colours.

Chemical Spills

Accidental spills of strong chemicals (e.g. paint stripper, brush cleaners, metal cleaners, oven cleaners, cleaners containing methylene chloride, acid drain cleaners, acetonebased nail polish removers, etc.) should be flushed promptly with plenty of soapy water to avoid damaging worktops. For nail varnish spills, non-acetone based remover can be used and then flushed with water. Undetected or prolonged exposure to chemicals may damage the surface.

保养与维护 Care and Maintenance

质量网络

为了将杜邦™可丽耐®材料制作成用户满意的作品,杜邦公司发展了严格的质量网络,致力于提供最优质的安装标准和服务。杜邦™可丽耐®质量网络成员被称作:杜邦™可丽耐®授权加工/安装商。

所有成员都经过杜邦公司在制造,安装,维修及杜邦™可丽耐®实体面材保养的方面的培训。质量网络成员也负责参与10年质保计划。

质保

杜邦公司提供两个级别的杜邦™可丽耐®质保,分别是产品层级与安装层级。产品保修标准是所有杜邦™可丽耐®产品的标准,确保顾客在购买之后10年之内可以获得免费质保,更高等级质保是有限安装质保,只限于由杜邦™可丽耐®授权加工/安装商加工和安装的可丽耐产品。该有限安装保修是产品保修的延伸,确保了制造和安装的成品不会出现质量缺陷。

Quality Network

In order to transform DuPont™ Corian® into designer creations, DuPont has developed a Quality Network of people dedicated to delivering the very best standards of installation and service.

The members of the DuPont™ Corian® Quality Network are called "Authorised DuPont™ Corian® fabricators/installers"

All members have been trained by DuPont in the fabrication, installation, repair and maintenance of DuPont™ Corian® solid surfaces. Quality Network members are also responsible for applying and fulfilling the 10-Year Limited Installed Warranty Program.

Warranty

DuPont offers two levels of warranty protection for DuPont™ Corian®: product and installed. The Product Warranty is standard for all DuPont™ Corian® products and ensures that they will be free of manufacturing defects for a period of 10 years after purchase. A higher level of coverage, the Limited Installed Warranty, is only available when fabrication and installation is carried out by a DuPont™ Corian® Quality Network fabricator. This Limited Installed Warranty expands the Product Warranty and also ensures that the fabrication and installation of the finished product will be free of defects. For further information, please contact your local DuPont™ Corian® office.



Photo credits (from top to bottom, from left to right)

- Cover Illuminated cubic seating, wall pannelling and wall lamp, design Rosita and Luca Missoni; "Onda" and "Esmeraldas" patterns by MissoniHome;
- Page 2 "Resi-Rise", Venice, 2004, installation by KOL/MAC Studio at IX Biennale di Architettura, photo courtesy of Leo Torri
- Page 6 Corian® design studio, Shanghai, China; design Michael Young; photo Fang Lei;
- Page 8 Left: "Dining by Design" by C.P. Arkey-Leliever, the Design Industries Foundation Fighting AIDS (DIFFA) event; Right: Butterfly Table, design Kimi Hasegawa (2007 Milan Week of design), photo Francesco Brigida for DuPont™ Corian®;
- Page 9 Right: "Bayadere" style kitchen, Arcachon, France; project and photo by Jean-Jacques Marvielle;
- Page 10 Right: Le Cob Bath by Vestrosystems; design Joseph Luciadi; photo Vestrosystems;
- Page 11 Left: Children pavillion Anansi, Utrecht, Netherlands; design Mulders vandenBerk Architecten photo Roel Backaert; Right: Seeko'o Hotel, Bordeaux, France, project by Atelier King Kong Architects; photo Arthur Pequign;
- Page 12 Left: American Standard International Headquarters Lobby, Piscataway, New Jersey, Dennis Posen, Rick Rubin, Lori Klein—Posen, Rubin & Rotman Architects Fabricator, Eagle Fabrication Inc.; Right: Illuminated cubic seating, wall pannelling and wall lamp, design Rosita and Luca Missoni; "Onda" and "Esmeraldas" patterns by MissoniHome;
- Page 13 Right: Oncology Centre in Bydgoszcz, Poland, 2008, photo CCI;
- Page 14 Lower Left: Corian® Illumination Wall at ZENSES Pissarro Dining Restaurant in Hong Kong; design Michael Young;
- Page 15 Right: "Shigemi-Lounge" design Shogo Kawata Architect Office
- Page 16 Left: Toilet in UA KK Mall, Shenzhen, China; design and photo by Alexander Wong Architects Limited; Right: DuPont™ Corian® for reception desk and for decorative wall cladding in Sofitel Hotel Louise, Brussels, Belgium; project by Architect Antoine Pinto; photo courtesy of Sofitel;
- Page 17 Top left: Corian® Cosmetic Counter in Hong Kong-Corian® Display Shelves at Stuart Weitzman shows shop, Hong Kong;
- Page 18 Right: Corian® design studio, Shanghai, China; design Michael Young; photo Fang Lei;

法律声明

知识产权

所有出现在这个文件/演示文稿中所包含的图片中的装饰品、解决方案、系统、产品、安装和设计是各自作者的知识产权。未经允许私自复制属于侵权,作者会保留追究权利。

知识产权及图片的使用

手册中所使用的图片,知识产权属 E.I. 杜邦和本公司或其附属公司,也即属于公司、建筑师、设计师,机构或其他单位或个人。未经授权对这些图像的使用会构成对知识产权、版权的侵犯。

LEGAL NOTICE





Intellectual Property

All the decorations, solutions, systems, products, installations and designs shown in the images included in this document/presentation are the intellectual property of their respective owners. Copying the decorations, solutions, systems, products, installations and designs shown in these images will result in the violation of the intellectual property of their respective owners. Persons infringing these intellectual property rights will be held accountable in accordance with applicable legislation.



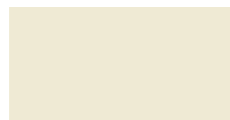
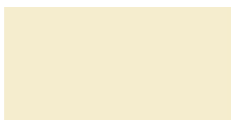



Property and Use of Images

The images used in this dossier are the property of E. I. du Pont de Nemours and Company or its affiliated companies or, alternatively, are the property of companies, architects, designers, organization or other entities or individuals. The unauthorized use of these images constitutes a violation of the laws on intellectual property and copyrights.

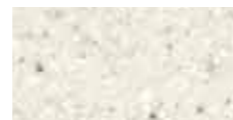

净色系列
Solid

			
雪白 GW 101 Glacier White	奶白 CW 103 Cameo White	香草 NL 114 Vanilla	珍珠灰 PG 115 Pearl Gray
			
银灰 VY 116 Silver Gray	墨灰 DY 117 Deep Gray	茶灰 EY 118 Elegant Gray	



山峰系列
Summit

			
黑石英 BQ 305 Black Quartz	雪花白 EV 502 Everest	峡谷 CN 511 Canyon	鲍鱼 AB 518 Abalone
			
夜空 NS 519 Night Sky	棕褐 SI 520 Sienna Brown	墨砥 ED 521 Medea	





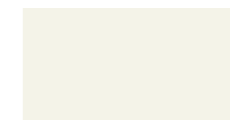
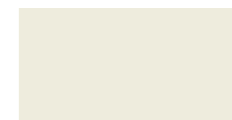





设计师系列
Designer Portfolio

			
桔子 DM 901 Mandarin	黑夜 DN 902 Nocturne	太阳 DS 903 Sun	火红 DH 906 Hot
			
设计师白 WN 910 Designer White			



透光系列
Translucent

			
冰川白 GC 951 Glacier Ice	冰月白 IW 952 Ice White	冰莓蓝 IY 953 Blueberry Ice	冰薄荷 IM 954 Mint Ice









麻石系列
Sierra

			
黑麻 SM 201 Midnight	灰麻 SD 203 Dusk	岩石麻 SS 204 Sandstone	杏仁麻 AR 209 Aurora
			
黄沙麻 JV 217 Mojave	亚麻布 LN 228 Linen	茉莉 WJ 229 White Jasmine	米纸 RP 230 Rice Paper
			
画布 CV 231 Canvas	灰鸽 DV 233 Dove	淡沙黄 WH 236 Whisper	











闪晶 / 金属系列
Sparklings/ Metallics

		
闪晶白 4B 922 Sparkling White	闪晶墨 AN 925 Anthracite	闪晶银 VM 924 Silerite



晶岩系列
Summit Magna

			
砂褐 MS 703 Sahara	南极 MT 707 Antarctica	平原 MV 708 Savannah	万花筒 TU 710 Tumbled Glass
			
古化石 DJ 717 Fossil	可可棕 CC 719 Cocoa Brown	浪花白 WC 720 Whitecap	银桦 SB 723 Silver Birch

珍藏系列
Private Collection

			
贝壳 CL 801 Clam Shell	粗沙 BH 802 Burled Beach	埃及铜 EG 805 Egyptian Copper	粗沙砾 NR 807 Sonora
			
云彩白 CR 815 Cirrus White	雨水白 RC 818 Rain Cloud	熔岩石 AA 821 Lava Rock	珍珠白 RL 822 Pearl
			
罗勒棕 JZ 823 Basil	乌金 MJ 824 Sorrel		

水纹系
Ripple

	
水纹白 RW 401 White Ripple	水纹灰 RG 402 Gray Ripple

暗纹系列
Venaro

暗纹白 VW 606 Venaro White

- 频繁使用后,在特殊光照下只显现非常轻微的痕迹。
- 频繁使用后,在特殊光照下会显现轻微的痕迹。
- 频繁使用后,会显现明显的使用痕迹。
- 十年内色彩变化小于等于 5 ΔE^*ab 单位,适用于外墙。
- 十年内色彩变化在 5 ΔE^*ab 单位到 15 ΔE^*ab 单位之间,适用于能够接受颜色轻微变化的应用。
- 十年内色彩变化大于 15 ΔE^*ab 单位,如果能够接受较大的颜色变化,那么可以作为备用选择。
- 板材厚度 4mm
- 板材厚度 6mm
- 板材厚度 12mm
- 板材厚度 19mm
- K K 厨房应用系列
- E E 外墙围护系列
- <II> 正常宽版 760mm
- <III> 宽板 930mm
- <IIII> 特宽板 1330mm

- Very light visible marks under specific lighting conditions after intense and heavy use.
- Light visible marks under specific lighting conditions after intense and heavy use.
- Visible marks after intense and heavy use.
- Colour change of less than or equal to 5 ΔE^*ab units in 10 years-good choices for exterior applications.
- Colour change of 5 to 15 ΔE^*ab units in 10 years-good choices if some colour change is not objectionable.
- Colour change of greater than 15 ΔE^*ab units in 10 years-potential choices if greater colour change is acceptable.
- Sheet thickness 4mm
- Sheet thickness 6mm
- Sheet thickness 12mm
- Sheet thickness 19mm
- K Kitchen collection
- E Exterior wall cladding collection
- <II> Sheet width 760mm (Normal)
- <III> Sheet width 930mm (Wide)
- <IIII> Sheet width 1300mm (Extra Wide)